

€ Euro-Lok



TWIN FERRULE

COMPRESSION FITTINGS



NOXON
TPP PACKAGES
PROJECTS
DIVISION INSTRUMENTATION

AS TOUGH AS STEEL IN STAINLESS

P.O. BOX 6096, NL-5700 ET HELMOND, THE NETHERLANDS

PHONE: +31(0) 492-582111 - FAX: +31(0) 492-538970

www.noxon.nl - info@noxon.nl

INTRODUCTION

The Euro-Lok range of Twin Ferrule Fittings is a well established design that is predominantly manufactured in 316 stainless steel for the petro-chemical, hydraulics, power generating, general engineering, gas and instrumentation industries.

The Euro-Lok fittings are produced in line with the Internationally accepted 'Twin Ferrule' design and as such are interchangeable with similar manufactured products made to the same specifications.

All products are manufactured within a Quality Control environment and system approved by the British Standards Institute to ISO 9002.

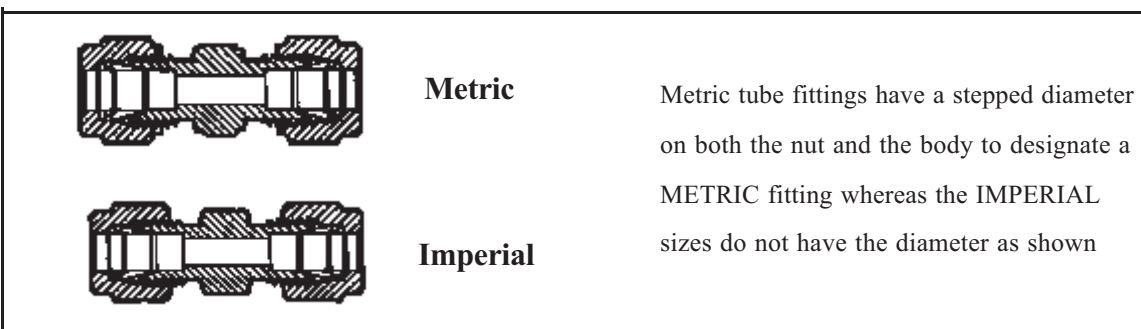
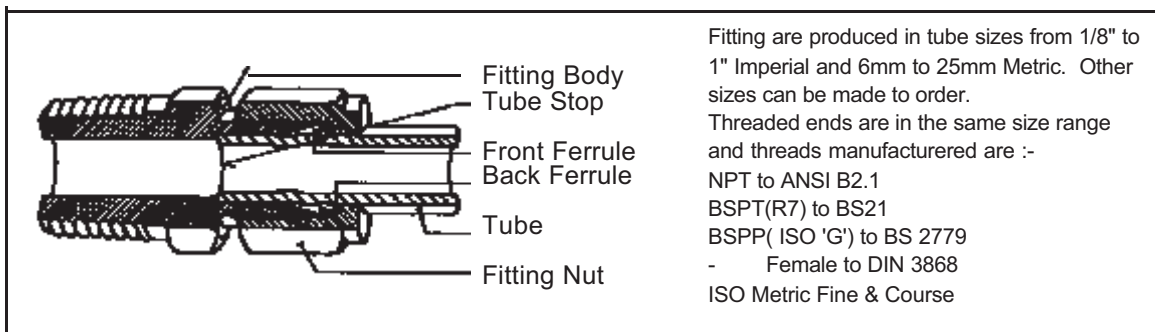

ADDITIONAL PRODUCTS

Instrumentation Pipe Fittings



A full range of pipe fitting including adaptors, reducing bushes, tees and elbows

Ball Valves

1/4" to 2" full and reduced bore in 316ss and exotic alloys.



Needle Valves

1/4" to 1" Male/Female, Female/female and compression ended, in 316ss and exotic alloys.



Manifold Valves

1/4" to 1/2" Remnote or Direct Mount valves in 2,3,4 and 5 Valve types to suit pressure and differential instruments, in 316ss and exotic alloys.



Block & Bleed Valves

1/4" to 2" Threaded and Flanged, Block, Block & Bleed and Double Block & Bleed styles, in 316ss and exotic alloys.



MC Male Connectors - Imperial

NPT/BSPT Threads

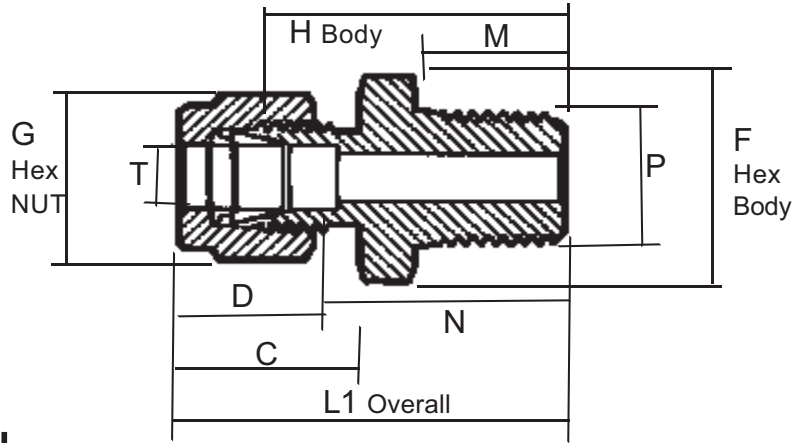

 Euro-Lok- Twin Ferrule Fittings

Imperial Range			Dimension in INCHES								Metric Range			Dimension in mm							
NPT Part Number	Tube o/dia	P Thread	L1	M	C	D	F	G	H	N	NPT Part Number	Tube o/dia	P Thread	L1	M	C	D	F	G	H	N
2MC2-N-S	1/8"	1/8"	1.19	0.38	0.63	0.53	1/2"	7/16"	0.91	0.41	6mMC2-N-S	6	1/8"	35	10	19	17	14	14	26	11.3
2MC4-N-S	1/8"	1/4"	1.41	0.56	0.63	0.53	9/16"	7/16"	1.13	0.50	6mMC4-N-S	6	1/4"	40	15	19	17	14	14	31	12.7
3MC2-N-S	3/16"	1/8"	1.21	0.38	0.63	0.54	7/16"	1/2"	0.95	0.43	6mMC6-N-S	6	3/8"	43	16	19	17	19	14	34	15.6
3MC4-N-S	3/16"	3/16"	1.42	0.56	0.63	0.54	9/16"	1/2"	1.16	0.54	6mMC8-N-S	6	1/2"	48	20	19	17	22	14	38	16.4
4MC2-N-S	1/4"	1/8"	1.29	0.38	0.70	0.60	1/2"	9/16"	1.00	0.45	8mMC4-N-S	8	1/4"	41	15	20	18	14	17	32	12.9
4MC4-N-S	1/4"	1/4"	1.50	0.56	0.70	0.60	9/16"	9/16"	1.19	0.50	10mMC4-N-S	10	1/4"	41.5	15	20.5	18	17	19	33	13.2
4MC6-N-S	1/4"	3/8"	1.51	0.56	0.70	0.60	11/16"	9/16"	1.19	0.56	10mMC6-N-S	10	3/8"	44.5	16	20.5	18	19	19	36	16.1
4MC8-N-S	1/4"	1/2"	1.73	0.75	0.70	0.60	7/8"	9/16"	1.44	0.67	10mMC8-N-S	10	1/2"	48.5	20	20.5	18	22	19	40	16.9
6MC2-N-S	3/8"	1/8"	1.38	0.38	0.76	0.66	5/8"	11/16"	1.09	0.48	10mMC12-N-S	10	3/4"	50.5	21	20.5	18	27	19	42	18.6
6MC4-N-S	3/8"	1/4"	1.57	0.56	0.76	0.66	5/8"	11/16"	1.28	0.57	12mMC4-N-S	12	1/4"	46	15	23	24	22	22	35	12.0
6MC6-N-S	3/8"	3/8"	1.57	0.56	0.76	0.66	11/16"	11/16"	1.28	0.56	12mMC6-N-S	12	3/8"	47	16	23	24	22	22	36	12.9
6MC8-N-S	3/8"	1/2"	1.79	0.75	0.76	0.66	7/8"	11/16"	1.50	0.67	12mMC8-N-S	12	1/2"	51	20	23	24	22	22	40	13.7
6MC12-N-S	3/8"	3/4"	1.82	0.75	0.76	0.66	1-1/16"	11/16"	1.53	0.68	12mMC12-N-S	12	3/4"	53	21	23	24	27	22	42	15.4
8MC4-N-S	1/2"	1/4"	1.71	0.56	0.86	0.90	13/16"	7/8"	1.31	0.47	15mMC8-N-S	15	3/8"	48	16	24	26	24	27	36	
8MC6-N-S	1/2"	3/8"	1.71	0.56	0.86	0.90	13/16"	7/8"	1.31	0.46	16mMC8-N-S	16	1/2"	52	20	24	26	24	27	40	12.1
8MC8-N-S	1/2"	1/2"	1.90	0.75	0.86	0.90	7/8"	7/8"	1.50	0.54	16mMC12-N-S	16	3/4"	50.5	21	20.5	18	27	19	42	13.8
8MC12-N-S	1/2"	3/4"	1.93	0.75	0.86	0.90	1-1/16"	7/8"	1.53	0.55	18mMC8-N-S	18	1/2"	52	20	24	26	27	30	40	12.1
12MC8-N-S	3/4"	1/2"	1.99	0.75	0.86	0.96	1-1/16"	1-1/8"	1.59	0.57	18mMC12-N-S	18	3/4"	54	21	24	26	27	30	42	13.8
12MC12-N-S	3/4"	3/4"	1.99	0.75	0.86	0.96	1-1/16"	1-1/8"	1.59	0.55	18mMC16-N-S	18	1"	58	25	24	26	36	30	46	14.3
12MC16-N-S	3/4"	1"	2.21	0.94	0.86	0.96	1-3/8"	1-1/8"	1.81	0.68	20mMC20-N-S	25	3/4"	62.5	21	31	36	36	41	46	
16MC12-N-S	1"	3/4"	2.26	0.75	1.04	1.23	1-3/8"	1-1/2"	1.78	0.55	25mMC12-N-S	25	3/4"	62.5	21	31	36	36	41	46	12.9
16MC16-N-S	1"	1"	2.45	0.94	1.04	1.23	1-3/8"	1-1/2"	1.97	0.65	25mMC16-N-S	25	1"	66.5	25	31	36	36	41	50	13.4

For BSPT Threads CHANGE 'N' for R in the PART Number.

Male Connectors - Metric

BSPG Threads

MC-G

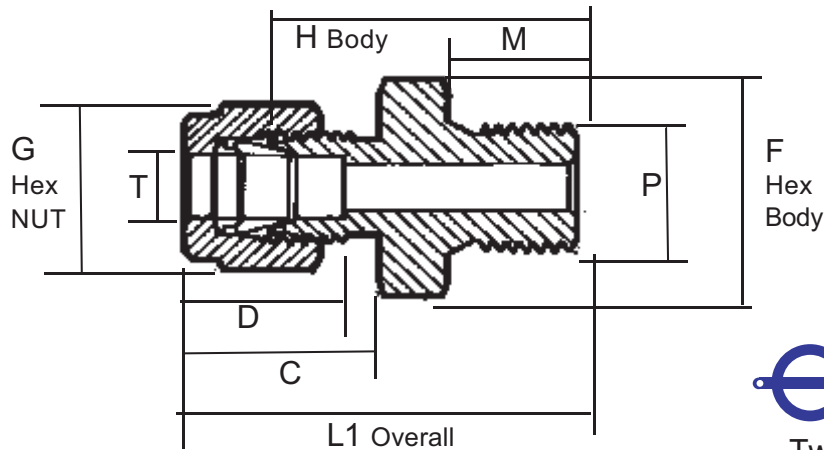

Euro-Lok
Twin Ferrule Fittings

Imperial Range											Metric Range										
Dimension in INCHES											Dimension in mm										
NPT Part Number	Tube o/dia	P Thread	L1	M	C	D	F	G	H	N	NPT Part Number	Tube o/dia	P Thread	L1	M	C	D	F	G	H	N
2MC2-G-S	1/8"	1/8"	1.19	0.38	0.63	0.53	1/2"	7/16"	0.91		6mMC2-G-S	6	1/8"	35	10	19	17	14	14	26	
2MC4-G-S	1/8"	1/4"	1.41	0.56	0.63	0.53	9/16"	7/16"	1.13		6mMC4-G-S	6	1/4"	40	15	19	17	14	14	31	
3MC2-G-S	3/16"	1/8"	1.21	0.38	0.63	0.54	7/16"	1/2"	0.95		6mMC6-G-S	6	3/8"	43	16	19	17	19	14	34	
3MC4-G-S	3/16"	3/16"	1.42	0.56	0.63	0.54	9/16"	1/2"	1.16		6mMC8-G-S	6	1/2"	48	20	19	17	22	14	38	
4MC2-G-S	1/4"	1/8"	1.29	0.38	0.70	0.60	1/2"	9/16"	1.00		8mMC4-G-S	8	1/4"	41	15	20	18	14	17	32	
4MC4-G-S	1/4"	1/4"	1.50	0.56	0.70	0.60	9/16"	9/16"	1.19												
4MC6-G-S	1/4"	3/8"	1.51	0.56	0.70	0.60	11/16"	9/16"	1.19		10mMC4-G-S	10	1/4"	41.5	15	20.5	18	17	19	33	
4MC8-G-S	1/4"	1/2"	1.73	0.75	0.70	0.60	7/8"	9/16"	1.44		10mMC6-G-S	10	3/8"	44.5	16	20.5	18	19	19	36	
											10mMC8-G-S	10	1/2"	48.5	20	20.5	18	22	19	40	
6MC2-G-S	3/8"	1/8"	1.38	0.38	0.76	0.66	5/8"	11/16"	1.09		10mMC12-G-S	10	3/4"	50.5	21	20.5	18	27	19	42	
6MC4-G-S	3/8"	1/4"	1.57	0.56	0.76	0.66	5/8"	11/16"	1.28												
6MC6-G-S	3/8"	3/8"	1.57	0.56	0.76	0.66	11/16"	11/16"	1.28		12mMC4-G-S	12	1/4"	46	15	23	24	22	22	35	
6MC8-G-S	3/8"	1/2"	1.79	0.75	0.76	0.66	7/8"	11/16"	1.50		12mMC6-G-S	12	3/8"	47	16	23	24	22	22	36	
6MC12-G-S	3/8"	3/4"	1.82	0.75	0.76	0.66	1-1/16"	11/16"	1.53		12mMC8-G-S	12	1/2"	51	20	23	24	22	22	40	
8MC4-G-S	1/2"	1/4"	1.71	0.56	0.86	0.90	13/16"	7/8"	1.31		12mMC12-G-S	12	3/4"	53	21	23	24	27	22	42	
8MC6-G-S	1/2"	3/8"	1.71	0.56	0.86	0.90	13/16"	7/8"	1.31												
8MC8-G-S	1/2"	1/2"	1.90	0.75	0.86	0.90	7/8"	7/8"	1.50		15mMC8-G-S	15	3/8"	48	16	24	26	24	27	36	
8MC12-G-S	1/2"	3/4"	1.93	0.75	0.86	0.90	1-1/16"	7/8"	1.53												
											16mMC8-G-S	16	1/2"	52	20	24	26	24	27	40	
12MC8-G-S	3/4"	1/2"	1.99	0.75	0.86	0.96	1-1/16"	1-1/8"	1.59		16mMC12-G-S	16	3/4"	50.5	21	20.5	18	27	19	42	
12MC12-G-S	3/4"	3/4"	1.99	0.75	0.86	0.96	1-1/16"	1-1/8"	1.59												
12MC16-G-S	3/4"	1"	2.21	0.94	0.86	0.96	1-3/8"	1-1/8"	1.81		18mMC8-G-S	18	1/2"	52	20	24	26	27	30	40	
											18mMC12-G-S	18	3/4"	54	21	24	26	27	30	42	
											18mMC16-G-S	18	1"	58	25	24	26	36	30	46	
16MC12-G-S	1"	3/4"	2.26	0.75	1.04	1.23	1-3/8"	1-1/2"	1.78												
16MC16-G-S	1"	1"	2.45	0.94	1.04	1.23	1-3/8"	1-1/2"	1.97		20mMC20-G-S	25	3/4"	62.5	21	31	36	36	41	46	
											25mMC12-G-S	25	3/4"	62.5	21	31	36	36	41	46	
											25mMC16-G-S	25	1"	66.5	25	31	36	36	41	50	



Female Connectors - Imperial & Metric

NPT/BSPT Threads

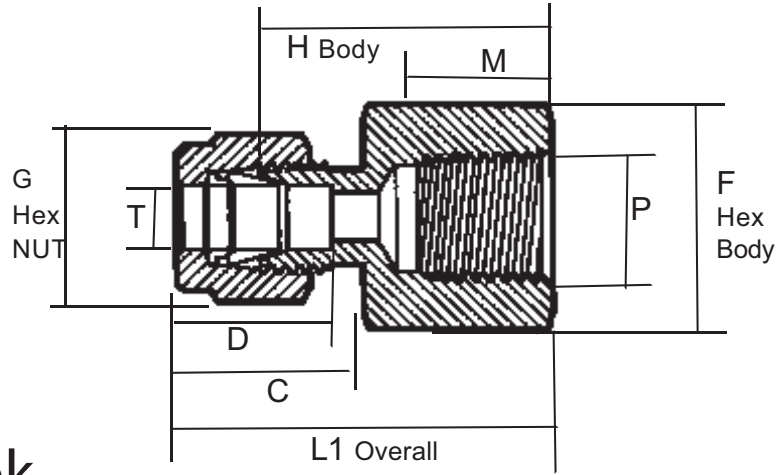

Euro-Lok
Twin Ferrule Fittings

Imperial Range										Metric Range									
Dimension in INCHES										Dimension in mm									
NPT Part Number	Tube o/dia	P Thread	L1	M	C	D	F	G	H	NPT Part Number	Tube o/dia	P Thread	L1	M	C	D	F	G	H
2FC2-N-S	1/8	1/8	1.16	0.39	0.63	0.53	9/16	7/16	0.88	6mFC2-N-S	6	1/8"	33	10	19	17	14	14	24
2FC4-N-S	1/8	1/4	1.34	0.59	0.63	0.53	3/4	7/16	1.06	6mFC4-N-S	6	1/4"	37	14	19	17	19	14	28
										6mFC6-N-S	6	3/8"	37	14	19	17	22	14	28
3FC2-N-S	3/16	1/8	1.17	0.39	0.63	0.54	9/16	9/16	0.91	6mFC8-N-S	6	1/2"	45	22	19	17	27	14	36
4FC2-N-S	1/4	1/8	1.23	0.39	0.70	0.60	9/16	9/16	0.94	8mFC4-N-S	8	1/4"	38	14	20	18	19	17	29
4FC4-N-S	1/4	1/4	1.41	0.59	0.70	0.60	3/4	9/16	1.12										
4FC6-N-S	1/4	3/8	1.48	0.59	0.70	0.60	7/8	9/16	1.19	10mFC4-N-S	10	1/4"	38.5	14	20.5	18	19	19	30
4FC8-N-S	1/4	1/2	1.70	0.78	0.70	0.60	1-1/16	9/16	1.41	10mFC6-N-S	10	3/8"	38.5	14	20.5	18	22	19	30
										10mFC8-N-S	10	1/2"	46.5	22	20.5	18	27	19	38
6FC2-N-S	3/8	1/8	1.29	0.39	0.76	0.66	5/8	11/16	1.00										
6FC4-N-S	3/8	1/4	1.48	0.59	0.76	0.66	3/4	11/16	1.19	12mFC4-N-S	12	1/4"	44	14	23	24	22	22	33
6FC6-N-S	3/8	3/8	1.54	0.59	0.76	0.66	7/8	11/16	1.25	12mFC6-N-S	12	3/8"	44	14	23	24	22	22	33
6FC8-N-S	3/8	1/2	1.73	0.78	0.76	0.66	1-1/16	11/16	1.44	12mFC8-N-S	12	1/2"	52	22	23	24	27	22	41
8FC4-N-S	1/2	1/4	1.65	0.59	0.86	0.90	13/16	7/8	1.25	16mFC8-N-S	16	1/2"	55	22	24	26	27	27	43
8FC6-N-S	1/2	3/8	1.65	0.59	0.86	0.90	7/8	7/8	1.25	18mFC8-N-S	18	1/2"	55	22	24	26	27	30	43
8FC8-N-S	1/2	1/2	1.84	0.78	0.86	0.90	1-1/16	7/8	1.44	18mFC12-N-S	18	3/4"	55	22	24	26	36	30	43
12FC8-N-S	3/4	1/2	1.84	0.78	0.86	0.96	1-1/16	1-1/8	1.44	20mFC12-N-S	20	3/4"	62.5	21	31	36	36	41	46
12FC12-N-S	3/4	3/4	1.90	0.81	0.86	0.96	1-5/16	1-1/8	1.50										
										25mFC12-N-S	25	3/4"	64.5	22	31	36	36	41	48
										25mFC16-N-S	25	1"	66.5	24	31	36	41	41	50
16FC12-N-S	1	3/4	2.10	0.81	1.04	1.23	1-3/8	1-1/2	1.62										
16FC16-N-S	1	1	2.45	1.00	1.04	1.23	1-5/8	1-1/2"	1.97										

For BSPT Threads CHANGE 'N' for R in the PART Number.

Female Connectors - Imperial & Metric

BSPP Threads

FC-G

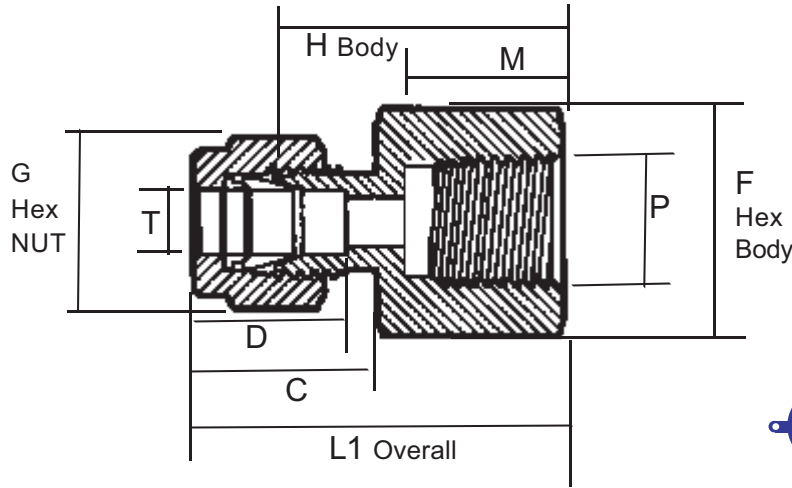

 Euro-Lok
Twin Ferrule Fittings

Imperial Range										Metric Range									
Dimension in INCHES										Dimension in mm									
NPT Part Number	Tube o/dia	P Thread	L1	M	C	D	F	G	H	NPT Part Number	Tube o/dia	P Thread	L1	M	C	D	F	G	H
2FC2-G-S	1/8	1/8	1.16	0.39	0.63	0.53	9/16	7/16	0.88	6mFC2-G-S	6	1/8"	33	10	19	17	14	14	24
2FC4-G-S	1/8	1/4	1.34	0.59	0.63	0.53	3/4	7/16	1.06	6mFC4-G-S	6	1/4"	37	14	19	17	19	14	28
3FC2-G-S	3/16	1/8	1.17	0.39	0.63	0.54	9/16	9/16	0.91	6mFC6-G-S	6	3/8"	37	14	19	17	22	14	28
4FC2-G-S	1/4	1/8	1.23	0.39	0.70	0.60	9/16	9/16	0.94	6mFC8-G-S	6	1/2"	45	22	19	17	27	14	36
4FC4-G-S	1/4	1/4	1.41	0.59	0.70	0.60	3/4	9/16	1.12	8mFC4-G-S	8	1/4"	38	14	20	18	19	17	29
4FC6-G-S	1/4	3/8	1.48	0.59	0.70	0.60	7/8	9/16	1.19	10mFC4-G-S	10	1/4"	38.5	14	20.5	18	19	19	30
4FC8-G-S	1/4	1/2	1.70	0.78	0.70	0.60	1-1/16	9/16	1.41	10mFC6-G-S	10	3/8"	38.5	14	20.5	18	22	19	30
6FC2-G-S	3/8	1/8	1.29	0.39	0.76	0.66	5/8	11/16	1.00	10mFC8-G-S	10	1/2"	46.5	22	20.5	18	27	19	38
6FC4-G-S	3/8	1/4	1.48	0.59	0.76	0.66	3/4	11/16	1.19	12mFC4-G-S	12	1/4"	44	14	23	24	22	22	33
6FC6-G-S	3/8	3/8	1.54	0.59	0.76	0.66	7/8	11/16	1.25	12mFC6-G-S	12	3/8"	44	14	23	24	22	22	33
6FC8-G-S	3/8	1/2	1.73	0.78	0.76	0.66	1-1/16	11/16	1.44	12mFC8-G-S	12	1/2"	52	22	23	24	27	22	41
8FC4-G-S	1/2	1/4	1.65	0.59	0.86	0.90	13/16	7/8	1.25	16mFC8-N-S	16	1/2"	55	22	24	26	27	27	43
8FC6-G-S	1/2	3/8	1.65	0.59	0.86	0.90	7/8	7/8	1.25	18mFC8-G-S	18	1/2"	55	22	24	26	27	30	43
8FC8-G-S	1/2	1/2	1.84	0.78	0.86	0.90	1-1/16	7/8	1.44	18mFC12-G-S	18	3/4"	55	22	24	26	36	30	43
12FC8-G-S	3/4	1/2	1.84	0.78	0.86	0.96	1-1/16	1-1/8	1.44	20mFC12-G-S	20	3/4"	62.5	21	31	36	36	41	46
12FC12-G-S	3/4	3/4	1.90	0.81	0.86	0.96	1-5/16	1-1/8	1.50	25mFC12-G-S	25	3/4"	64.5	22	31	36	36	41	48
16FC12-G-S	1	3/4	2.10	0.81	1.04	1.23	1-3/8	1-1/2	1.62	25mFC16-G-S	25	1"	66.5	24	31	36	41	41	50
16FC16-G-S	1	1	2.45	1.00	1.04	1.23	1-5/8	1-1/2"	1.97										

U

EQUAL UNION - Imperial / Metric

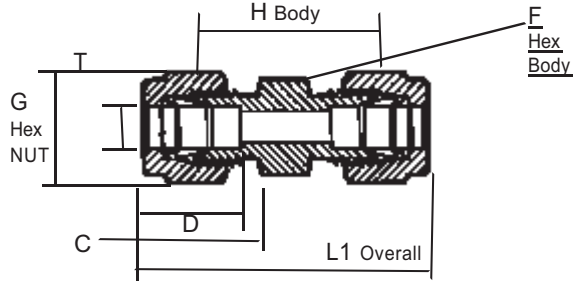

Imperial Range								Metric Range							
Dimension in INCHES								Dimension in mm							
Part Number	Tube o/d	L1 Length	C	D	F Hex	G Nut	H	Part Number	Tube o/d	L1 Length	C	D	F Hex	G Nut	H
2U-S	1/4	1.44	0.63	0.53	1/2	7/16	0.88	6mU-S	6	44	19	17	14	14	26
3U-S	3/16	1.47	0.63	0.54	1/2	1/2	0.95	8mU-S	8	46	20	18	14	17	28
4U-S	1/4	1.61	0.70	0.60	1/2	9/16	1.03	10mU-S	10	49	20.5	18	17	19	30
6U-S	3/8	1.77	0.76	0.66	5/8	11/16	1.19	12mU-S	12	54	23	24	22	22	32
8U-S	1/2	2.02	0.86	0.90	13/16	7/8	1.22	16mU-S	16	56	24	26	24	27	32
								18mU-S	18	58	24	26	27	30	34
12U-S	3/4	2.11	0.86	0.96	1-1/16	1-1/8	1.31	20mU-S	20						
								25mU-S	25	72	31	36	36	41	39
16U-S	1	2.55	1.04	1.23	1-3/8	1-1/2	1.59								

RU

REDUCING UNION - Imperial/Metric

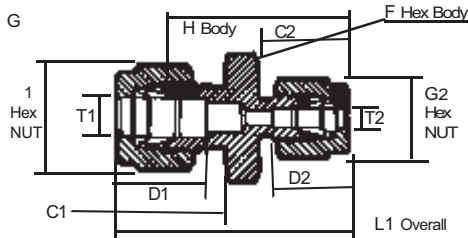

Imperial Range												Metric Range											
Dimension in INCHES												Dimension in mm											
Part Number	T1 o/d	T2 o/d	L1	C1	C2	D1	D2	F	G1 Nut	G2 Nut	H	Part Number	T1 o/d	T2 o/d	L1	C1	C2	D1	D2	F	G1 Nut	G2 Nut	H
3RU2-S	3/16	1/8	1.48	0.66	0.63			1/2	1/2	7/16	0.92												
												8-6mRU-S	8	6	46	20	19			14	17	14	27
4RU2-S	1/4	1/8	1.56	0.72	0.63			1/2	9/16	7/16	0.97												
4RU3-S	1/4	3/16	1.55	0.70	0.63			1/2	9/16	1/2	1.00	10-6mRU-S	10	6	45.5	20.5	19			17	19	14	28
												10-8mRU-S	10	8	46.5	20.5	20			17	19	17	29
6RU4-S	3/8	1/4	1.70	0.76	0.70			9/16	5/8	9/16	1.08												
												12-6mRU-S	12	6	50	23	19			22	22	14	30
8RU4-S	1/2	1/4	1.85	0.86	0.70			13/16	7/8	9/16	1.16	12-10mRU-S	12	10	51.5	23	20.5			22	22	19	32
8RU6-S	1/2	3/8	1.91	0.86	0.76			13/16	7/8	11/16	1.22												
12RU8-S	3/4	1/2	2.11	0.86	0.86			1-1/16	1-1/8	7/8	1.31												
16RU12-S	1	1/2																					

UNION CROSS - Imperial/Metric

CR

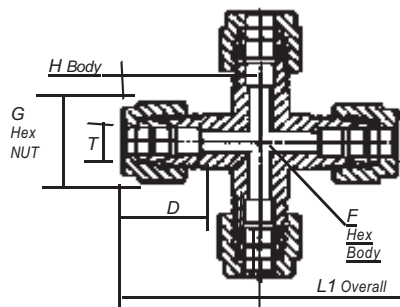

Imperial Range		Dimension in INCHES					Metric Range		Dimension in mm				
Part Number	Tube o/d	D	F	G Nut	H	L1	Part Number	Tube o/d	D	F	G Nut	H	L1
2CR-S	1/8	0.53	0.53	7/16	0.72	1.98	6mCR-S	6	17	12	14	20	58
4CR-S	1/4	0.60	0.50	9/16	0.78	2.14	8mCR-S	8	18	14	17	22	62
6CR-S	3/8	0.66	0.62	11/16	0.91	2.40	10mCR-S	10	18	19	19	25	67
8CR-S	1/2	0.90	0.81	7/8	0.98	2.76	12mCR-S	12	24	19	22	25	72
							16mCR-S	16	26	24	27	27	78

UNION TEE - Imperial/Metric

TTT

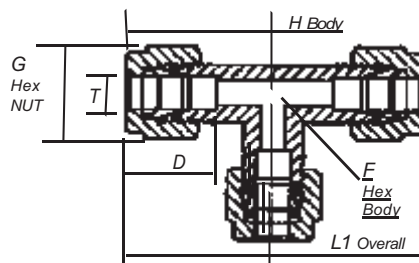

Imperial Range		Dimension in INCHES					Metric Range		Dimension in mm				
Part Number	Tube o/d	D	F A/F	G Nut	H	L1	Part Number	Tube o/d	D	F A/F	G Nut	H	L1
2TTT-S	1/8	0.50	0.47	7/16	0.72	1.98	6mTTT-S	6	17	12	14	19.5	57
4TTT-S	1/4	0.60	0.47	9/16	0.78	2.25	8mTTT-S	8	18	14	17	22	62
6TTT-S	3/8	0.66	0.55	11/16	0.91	2.40	10mTTT-S	10	18	19	19	25	67
8TTT-S	1/2	1.38	0.75	7/8	0.98	2.76	12mTTT-S	12	24	19	22	25	72
12TTT-S	3/4	0.96	1.06	1-1/8	1.11	3.02	16mTTT-S	16	26	24	27	27	78
16TTT-S	1	1.23	1.25	1-1/2	1.31	3.58	20mTTT-S	20	24	27	32	29.5	78
							25mTTT-S	25	36	32	41	33.5	100

MALE BULKHEAD CONNECTOR UNION

MBH

Imperial/Metric

Euro-Lok
Twin Ferrule Fittings

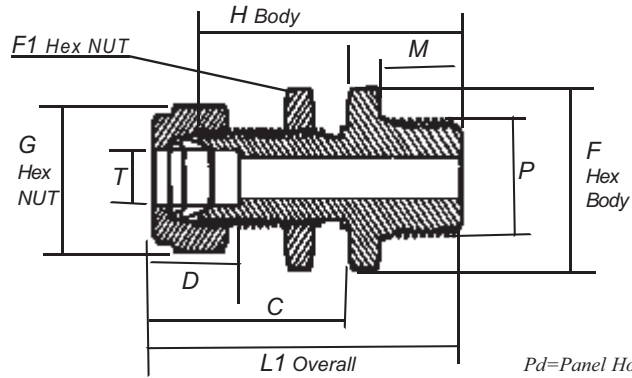

Pd=Panel Hole Diameter
Pm=Panel Max thickness

Imperial Range													Metric Range												
Dimension in INCHES													Dimension in mm												
Part Number	Tube o/d	P	M	D	F	F1	G Nut	H	C	L1	Pd	Pm	Part Number	T o/d	P	M	D	F	F1	G Nut	H	C	L1	Pd	Pm
4MBH2-N-S	1/4	1/8	0.38	0.60	5/8	5/8	9/16	1.66	1.32	1.95	0.45	0.4	6mMBH2-N-S	6	1/8"	10	17	14	17	14	42	35	51	11.6	12
4MBH4-N-S	1/4	1/4	0.56	0.60	5/8	5/8	9/16	1.81	1.32	2.10	0.45	0.4	6mMBH4-N-S	6	1/4"	15	17	14	17	14	47	35	56	11.6	12
6MBH4-N-S	3/8	1/4	0.56	0.66	3/4	3/4	11/16	1.97	1.45	2.26	0.58	0.4	10mMBH4-N-S	10	1/4"	15	18	17	19	19	52	38	60.5	16.4	10
8MBH8-N-S	1/2	1/2	0.75	0.90	15/16	7/8	15/16	2.28	1.65	2.68	0.77	0.5	12mMBH8-N-S	12	1/2"	20	24	22	24	22	60	43	71	19.5	14

FEMALE BULKHEAD CONNECTOR UNION

FBH

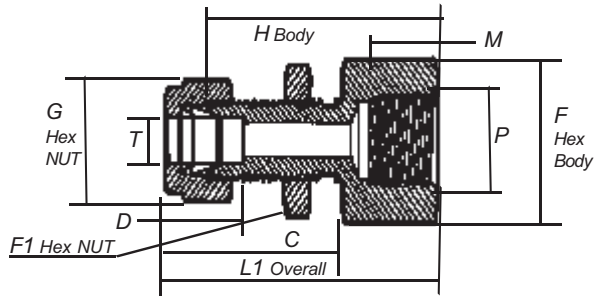

Pd=Panel Hole Diameter
Pm=Panel Max thickness

Imperial Range													Metric Range												
Dimension in INCHES													Dimension in mm												
Part Number	Tube o/d	P	M	D	F	F1	G Nut	H	C	L1	Pd	Pm	Part Number	T o/d	P	M	D	F	F1	G Nut	H	C	L1	Pd	Pm
4FBH2-N-S	1/4	1/8	0.39	0.60	5/8	5/8	9/16	1.56	1.32	1.85	0.45	0.4	6mFBH2-N-S	6	1/8"	10	17	14	17	14	42	35	48	11.6	12
4FBH4-N-S	1/4	1/4	0.59	0.60	3/4	5/8	9/16	1.75	1.32	2.04	0.45	0.4	6mFBH4-N-S	6	1/4"	15	17	14	17	14	44	35	53	11.6	12
6FBH4-N-S	3/8	1/4	0.59	0.66	3/4	3/4	11/16	1.88	1.45	2.17	0.58	0.4	10mFBH4-N-S	10	1/4"	15	18	17	19	19	47	38	55.5	16.4	10
8FBH6-N-S	1/2	3/8	0.59	0.90	15/16	15/16	7/8	2.03	1.65	2.43	0.77	0.5	12mFBH6-N-S	12	3/8"	16	24	22	24	22	50	43	61	19.5	14
8FBH8-N-S	1/2	1/2	0.78	0.90	1-1/16	15/16	7/8	2.22	1.65	2.62	0.77	0.5	12mFBH8-N-S	12	1/2"	20	24	27	24	22	58	43	69	19.5	14

For BSPT Threads CHANGE 'N' for R in the PART Number.

BHU BULKHEAD UNION - Imperial/Metric

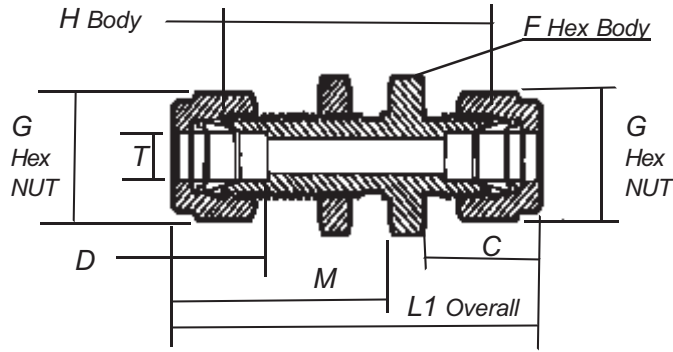

Pd=Panel Hole Diameter
Pm=Panel Max thickness

Imperial Range											Metric Range										
Dimension in INCHES											Dimension in mm										
Part Number	Tube o/d	M	D	F	G Nut	H	C	L1	Pd	Pm	Part Number	Tube o/d	M	D	F	G Nut	H	C	L1	Pd	Pm
2BHU-S	1/8	1.25	0.53	1/2	7/16	1.57	0.63	2.1	21/64	0.40	6mBHU-S	6	35	17	17	14	43	19	61	11.6	12
4BHU-S	1/4	1.32	0.60	5/8	9/16	1.69	0.70	2.27	29/64	0.40	8mBHU-S	8	37.5	18	17	17	46	20	64	13.2	14
6BHU-S	3/8	1.45	0.66	3/4	11/16	1.88	0.76	2.46	37/64	0.40	10mBHU-S	10	38	18	19	19	48	20.5	65	16.4	10
8BHU-S	1/2	1.65	0.90	15/16	7/8	2.00	0.86	2.80	49/64	0.50	12mBHU-S	12	43	24	24	22	51	23	73	19.5	14
12BHU-S	3/4	1.87	0.96	13/16	1-1/8	2.31	0.86	3.11	1-1/16	0.67	16mBHU-S	16	44.5	26	27	27	52.5	24	76.5	22.7	14
16BHU-S	1"	2.26	1.23	1-5/8	1-1/2	2.81	1.04	3.75	1-21/64	0.88	18mBHU-S	18	49.5	26	30	30	59	24	83	25.9	18
											25mBHU-S	25	62	36	41	41	72	31	105	33.8	27

ELU UNION ELBOW - Imperial / Metric

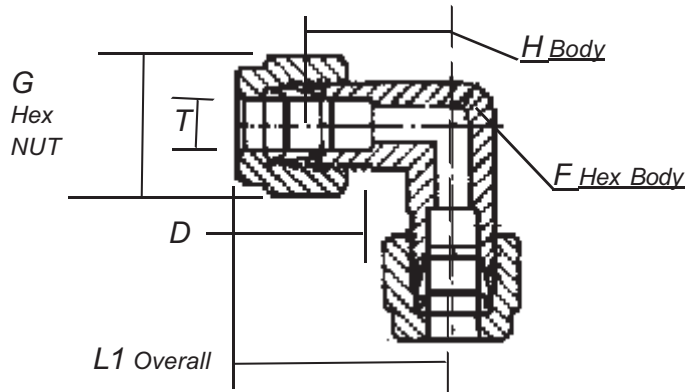

Imperial Range								Metric Range						
Dimension in INCHES								Dimension in mm						
Part Number	Tube o/d	D	F	G Nut	H	L1		Part Number	Tube o/d	D	F	G Nut	H	L1
2ELU-S	1/8	0.53	0.47	7/16	0.72	0.94		6mELU-S	6	17	12	14	19.5	28.5
4ELU-S	1/4	0.60	0.47	9/16	0.78	1.07		8mELU-S	8	18	14	17	22	31
6ELU-S	3/8	0.66	0.55	11/16	0.91	1.20		10mELU-S	10	18	19	19	25	33.5
8ELU-S	1/2	0.90	0.74	7/8	0.98	1.38		12mELU-S	12	24	19	22	25	36
12ELU-S	3/4	0.96	1.06	1-1/8	1.11	1.51		16mELU-S	16	26	24	27	27	39
16ELU-S	1	1.23	1.26	1-1/2	1.31	1.79		18mELU-S	18	26	27	30	29	41
								25mELU-S	25	36	32	41	33.5	50



MALE BRANCH TEE - Imperial/Metric

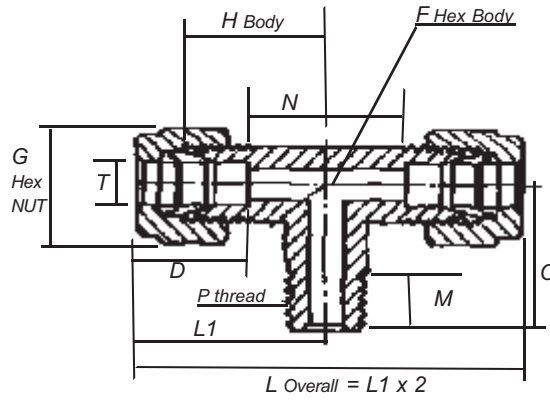

- Twin Ferrule Fittings

Imperial Range											Metric Range										
Dimension in INCHES											Dimension in mm										
Part Number	Tube o/d	P Thread	L1	M	C	D	F A/F	G Nut	H	N	Part Number	Tube o/d	P Thread	L1	M	C	D	F A/F	G Nut	H	N
											6mTTM2-N-S	6	1/8"	28.5	10	19	17	12	14	19.5	
											6mTTM4-N-S	6	1/4"	28.5	15	26	17	12	14	19.5	
2TTM2-N-S	1/8"	1/8"	0.99	0.38	0.76	0.50	0.47	7/16	0.72		6mTTM6-N-S	6	3/8"	30.5	16	28.5	17	14	14	21.5	
2TTM4-N-S	1/8"	1/4"	0.99	0.56	0.94	0.50	0.47	7/16	0.72		6mTTM8-N-S	6	1/2"	32	20	32.5	17	19	14	23	
											8mTTM2-N-S	8	1/8"	31	10	20	18	14	17	22	
4TTM2-N-S	1/4"	1/8"	1.07	0.38	0.76	0.60	0.47	9/16	0.78		8mTTM4-N-S	8	1/4"	31	15	27	18	14	17	22	
4TTM4-N-S	1/4"	1/4"	1.07	0.56	0.94	0.60	0.47	9/16	0.78		8mTTM6-N-S	8	3/8"	31.5	16	28.5	18	14	17	22.5	
4TTM6-N-S	1/4"	3/8"	1.13	0.56	1.00	0.60	0.55	9/16	0.84		8mTTM8-N-S	8	1/2"	33	20	32.5	18	19	17	24	
											10mTTM2-N-S	10	1/8"	35	10	24	18	14	19	26.5	
6TTM2-N-S	3/8"	1/8"	1.21	0.38	0.76	0.66	0.55	11/16	0.91		10mTTM4-N-S	10	1/4"	33.5	15	28	18	19	19	25	
6TTM4-N-S	3/8"	1/4"	1.21	0.56	1.00	0.66	0.55	11/16	0.91		10mTTM6-N-S	10	3/8"	33.5	16	29	18	19	19	25	
6TTM6-N-S	3/8"	3/8"	1.21	0.56	1.00	0.66	0.55	11/16	0.91		10mTTM8-N-S	10	1/2"	33.5	20	32.5	18	19	19	25	
6TTM8-N-S	3/8"	1/2"	1.21	0.75	1.26	0.66	0.75	11/16	0.91												
											12mTTM4-N-S	12	1/4"	36	15	28	24	19	22	25	
											12mTTM6-N-S	12	3/8"	36	16	29	24	19	22	25	
8TTM4-N-S	1/2"	1/4"	1.38	0.56	1.08	1.38	0.75	7/8	0.98		12mTTM8-N-S	12	1/2"	36	20	32.5	24	19	22	25	
8TTM6-N-S	1/2"	3/8"	1.38	0.56	1.08	1.38	0.75	7/8	0.98												
8TTM8-N-S	1/2"	1/2"	1.38	0.75	1.26	1.38	0.75	7/8	0.98		16mTTM8-N-S	16	1/2"	39	20	34.5	26	24	27	27	

For BSPT Threads CHANGE 'N' for R in the PART Number.



MALE ELBOW - Imperial / Metric

NPT / BSPT Threads

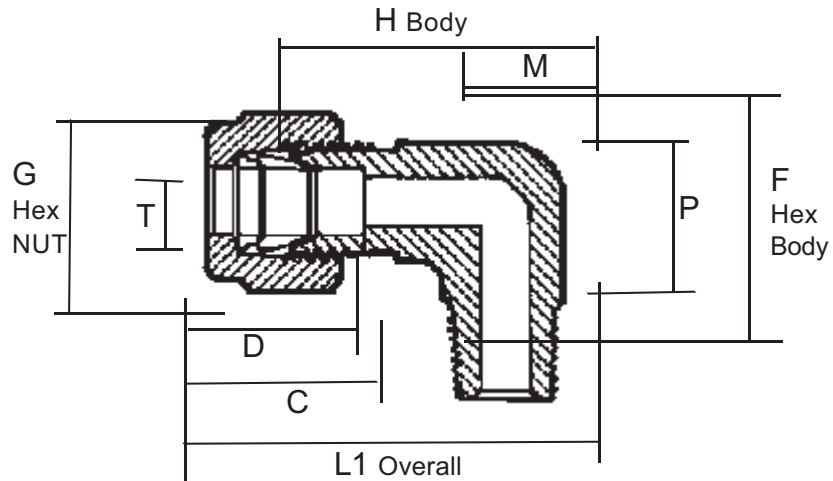

Euro-Lok Twin Ferrule Fittings

Imperial Range										Metric Range									
Dimension in INCHES										Dimension in mm									
NPT Part Number	Tube o/dia	P Thread	L1	M	C	D	F	G	H	NPT Part Number	Tube o/dia	P Thread	L1	M	C	D	F	G	H
2ME2-N-S	1/8	1/8	1.16	0.39	0.63	0.53	9/16	7/16	0.88	6mME2-N-S	6	1/8"	33	10	19	17	14	14	24
2ME4-N-S	1/8	1/4	1.34	0.59	0.63	0.53	3/4	7/16	1.06	6mME4-N-S	6	1/4"	37	14	19	17	19	14	28
										6mME6-N-S	6	3/8"	37	14	19	17	22	14	28
3ME2-N-S	3/16	1/8	1.17	0.39	0.63	0.54	9/16	9/16	0.91	6mME8-N-S	6	1/2"	45	22	19	17	27	14	36
4ME2-N-S	1/4	1/8	1.23	0.39	0.70	0.60	9/16	9/16	0.94	8mME4-N-S	8	1/4"	38	14	20	18	19	17	29
4ME4-N-S	1/4	1/4	1.41	0.59	0.70	0.60	3/4	9/16	1.12										
4ME6-N-S	1/4	3/8	1.48	0.59	0.70	0.60	7/8	9/16	1.19	10mME4-N-S	10	1/4"	38.5	14	20.5	18	19	19	30
4ME8-N-S	1/4	1/2	1.70	0.78	0.70	0.60	1-1/16	9/16	1.41	10mME6-N-S	10	3/8"	38.5	14	20.5	18	22	19	30
										10mME8-N-S	10	1/2"	46.5	22	20.5	18	27	19	38
6ME2-N-S	3/8	1/8	1.29	0.39	0.76	0.66	5/8	11/16	1.00										
										12mME4-N-S	12	1/4"	44	14	23	24	22	22	33
6ME6-N-S	3/8	3/8	1.54	0.59	0.76	0.66	7/8	11/16	1.25	12mME6-N-S	12	3/8"	44	14	23	24	22	22	33
6ME8-N-S	3/8	1/2	1.73	0.78	0.76	0.66	1-1/16	11/16	1.44	12mME8-N-S	12	1/2"	52	22	23	24	27	22	41
8ME4-N-S	1/2	1/4	1.65	0.59	0.86	0.90	13/16	7/8	1.25	16mME8-N-S	16	1/2"	55	22	24	26	27	27	43
8ME6-N-S	1/2	3/8	1.65	0.59	0.86	0.90	7/8	7/8	1.25	18mME8-N-S	18	1/2"	55	22	24	26	27	30	43
8ME8-N-S	1/2	1/2	1.84	0.78	0.86	0.90	1-1/16	7/8	1.44	18mME12-N-S	18	3/4"	55	22	24	26	36	30	43
12ME8-N-S	3/4	1/2	1.84	0.78	0.86	0.96	1-1/16	1-1/8	1.44	20mME12-G-S	20	3/4"	62.5	21	31	36	36	41	46
12ME12-N-S	3/4	3/4	1.90	0.81	0.86	0.96	1-5/16	1-1/8	1.50										
										25mME12-N-S	25	3/4"	64.5	22	31	36	36	41	48
										25mME16-N-S	25	1"	66.5	24	31	36	41	41	50
16ME12-N-S	1	3/4	2.10	0.81	1.04	1.23	1-3/8	1-1/2	1.62										
16ME16-N-S	1	1	2.45	1.00	1.04	1.23	1-5/8	1-1/2"	1.97										

For BSPT Threads CHANGE 'N' for R in the PART Number.

FEMALE RUN TEE - Imperial/Metric

TFT

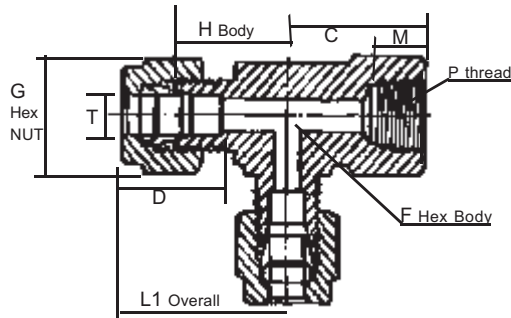

 Euro-Lok Twin Ferrule Fittings

Imperial Range										Metric Range									
Dimension in INCHES										Dimension in mm									
Part Number	Tube o/d	P Thread	L1	M	C	D	F A/F	G Nut	H	Part Number	Tube o/d	P Thread	L1	M	C	D	F A/F	G Nut	H
2TFT2-N-S	1/8"	1/8"	0.95	0.39	0.75	0.50	0.50	7/16	0.69	6mTFT2-N-S	6	1/8"	29	10	20	17	12	14	20
2TFT4-N-S	1/8"	1/4"	1.07	0.59	0.88	0.50	0.69	7/16	0.81	6mTFT4-N-S	6	1/4"	32	14	23	17	19	14	23
										6mTFT6-N-S	6	3/8"	34	20	43	17	24	14	25
										6mTFT8-N-S	6	1/2"	36	22	28	17	27	14	27
4TFT2-N-S	1/4"	1/8"	1.04	0.39	0.75	0.60	0.50	9/16	0.75										
4TFT4-N-S	1/4"	1/4"	1.17	0.59	0.88	0.60	0.59	9/16	0.88	8mTFT2-N-S	8	1/8"	30	10	23	18	12	17	21
										8mTFT4-N-S	8	1/4"	33	14	23	18	19	17	24
										8mTFT6-N-S	8	3/8"	35	14	23	18	24	17	26
										8mTFT8-N-S	8	1/2"	37	22	38	18	27	17	28
6TFT4-N-S	3/8"	1/4"	1.23	0.59	0.88	0.66	0.69	11/16	0.94	10mTFT2-N-S	10	1/8"	33.5	10	23	18	19	19	25
6TFT6-N-S	3/8"	3/8"	1.23	0.56	1.00	0.66	0.55	11/16	0.91	10mTFT4-N-S	10	1/4"	33.5	14	23	18	19	19	25
6TFT8-N-S	3/8"	1/2"	1.21	0.75	1.26	0.66	0.75	11/16	0.91	10mTFT6-N-S	10	3/8"	35.5	14	23	18	24	19	27
										10mTFT8-N-S	10	1/2"	37.5	22	28	18	27	19	29
8TFT4-N-S	1/2"	1/4"	1.38	0.56	0.88	1.38	0.81	7/8	1.03	12mTFT4-N-S	12	1/4"	36	14	23	24	19	22	25
8TFT6-N-S	1/2"	3/8"	1.43	0.59	0.88	1.38	0.81	7/8	1.03	12mTFT6-N-S	12	3/8"	38	14	23	24	24	22	27
8TFT8-N-S	1/2"	1/2"	1.52	0.78	1.12	1.38	1.00	7/8	1.12	12mTFT8-N-S	12	1/2"	40	22	28	24	27	22	29
										16mTFT8-N-S	16	1/2"	41	22	28	26	27	27	29

For BSPT Threads CHANGE 'N' for R in the PART Number.

MSA MALE ADAPTOR - MaleStand Pipe

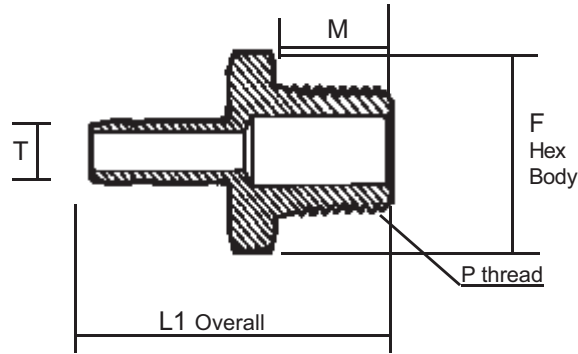

- Twin Ferrule Fittings

Imperial Range		Dimension in INCHES				Metric Range		Dimension in mm			
NPT Part Number	Tube o/dia	P Thread	M	F A/F	L1	NPT Part Number	Tube o/dia	P Thread	M	F	L1
2MSA2-N-S	1/8"	1/8"	0.38	1/2"	1-1/8	6mMSA2-N-S	6	1/8"	10	14	32
						6mMSA4-N-S	6	1/4"	15	14	37
2MSA4-N-S	1/8"	1/4"	0.56	9/16	1-5/16	6mMSA6-N-S	6	3/8"	16	19	38
						6mMSA8-N-S	6	1/2"	20	22	42
4MSA2-N-S	1/4"	1/8"	0.38	7/16	1-7/32	8mMSA4-N-S	8	1/4"	15	14	38
4MSA4-N-S	1/4"	1/4"	0.56	9/16	1-13/32	8mMSA6-N-S	8	3/8"	16	19	39
4MSA6-N-S	1/4"	3/8"	0.56	11/16	1-7/16	8mMSA8-N-S	8	1/2"	20	22	43
4MSA8-N-S	1/4"	1/2"	0.75	15/16	1-1/32						
						10mMSA4-N-S	10	1/4"	15	14	39
						10mMSA6-N-S	10	3/8"	16	19	40
6MSA4-N-S	3/8"	1/4"	0.56	9/16	1-1/2	10mMSA8-N-S	10	1/2"	20	22	46
6MSA6-N-S	3/8"	3/8"	0.56	11/16	1-1/2						
6MSA8-N-S	3/8"	1/2"	0.75	15/16	1-11/16	12mMSA4-N-S	12	1/4"	15	14	44
						12mMSA6-N-S	12	3/8"	16	19	45
						12mMSA8-N-S	12	1/2"	20	22	51
8MSA4-N-S	1/2"	1/4"	0.56	1/2	1-11/16						
8MSA6-N-S	1/2"	3/8"	0.56	11/16	1-3/4	16mMSA6-N-S	16	3/8"	16	19	48
8MSA8-N-S	1/2"	1/2"	0.75	15/16	1-15/16	16mMSA8-N-S	16	1/2"	20	22	52
						16mMSA12-N-S	16	3/4"	21	27	53
12MSA8-N-S	3/4"	1/2"	0.75	15/16	2.0	18mMSA8-N-S	18	1/2"			
12MSA12-N-S	3/4"	3/4"	0.75	1-1/16	2-1/32	18mMSA12-N-S	18	3/4"			
12MSA16-N-S	3/4"	1"	0.94	1-3/8	2-9/32	18mMSA16-N-S	18	1"			
16MSA12-N-S	1"	3/4"	0.75	1-1/16	2-9/32	20mMSA20-N-S	20	3/4"			
16MSA16-N-S	1"	1"	0.94	1-3/8	2-9/32						
						25mMSA12-N-S	25	3/4"	21	27	60
						25mMSA16-N-S	25	1"	25	36	65

For BSPT Threads CHANGE 'N' for R in the PART Number.

FEMALE Standpipe Adaptor

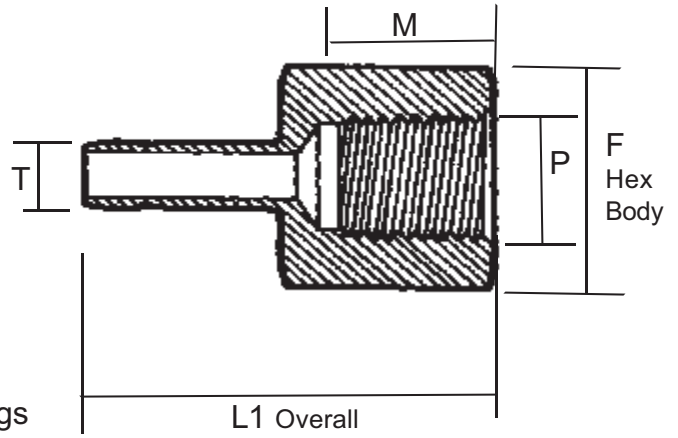

Euro-Lok - Twin Ferrule Fittings

Imperial Range						Metric Range					
Dimension in INCHES						Dimension in mm					
NPT Part Number	Tube o/dia	P Thread	M	F A/F	L1	NPT Part Number	Tube o/dia	P Thread	M	F	L1
						6mFSA2-N-S	6	1/8"	10	14	31
2FSA2-N-S	1/8"	1/8"	0.39	9/16"	1-5/32	6mFSA4-N-S	6	1/4"	14	19	35
						6mFSA6-N-S	6	3/8"	16	22	38
						6mFSA8-N-S	6	1/2"	22	27	42
4FSA2-N-S	1/4"	1/8"	0.39	9/16	1-5/32						
4FSA4-N-S	1/4"	1/4"	0.59	3/4	1-11/32	8mFSA4-N-S	8	1/4"	14	19	36
4FSA6-N-S	1/4"	3/8"	0.59	7/8	1-17/32	8mFSA6-N-S	8	3/8"	14	22	36
4FSA8-N-S	1/4"	1/2"	0.78	1-1/16	1-19/32	8mFSA8-N-S	8	1/2"	22	27	44
						10mFSA4-N-S	10	1/4"	15	14	39
6FSA4-N-S	3/8"	1/4"	0.59	3/4	1-13/32	10mFSA6-N-S	10	3/8"	16	19	40
6FSA6-N-S	3/8"	3/8"	0.59	7/8	1-15/32	10mFSA8-N-S	10	1/2"	20	22	46
6FSA8-N-S	3/8"	1/2"	0.78	1-1/16	1-21/32						
						12mFSA6-N-S	12	3/8"	14	22	42
8FSA4-N-S	1/2"	1/4"	0.56	1/2	1-11/16	12mFSA8-N-S	12	1/2"	22	27	50
8FSA6-N-S	1/2"	3/8"	0.56	11/16	1-3/4						
8FSA8-N-S	1/2"	1/2"	0.75	15/16	1-15/16	16mFSA6-N-S	16	3/8"	14	22	45
						16mFSA8-N-S	16	1/2"	22	27	52
12FSA8-N-S	3/4"	1/2"	0.78	1-1/16	2.0	18mFSA8-N-S	18	1/2"	22	27	53
12FSA12-N-S	3/4"	3/4"	0.78	1-5/16	2-1/16	18mFSA12-N-S	18	3/4"	22	36	53
12FSA16-N-S	3/4"	1"	0.94	1-3/8	2-9/32						

For BSPT Threads CHANGE 'N' for R in the PART Number.

PLUGS

Imperial Range Dimension in INCHES			Metric Range Dimension in mm		
Part Number	G Nut	T	Part Number	G Nut	T
2PLUG-S	7/16	1/8	6mPLUG-S	14	6
4PLUG-S	9/16	1/4	8mPLUG-S	17	8
6PLUG-S	11/16	3/8	10mPLUG-S	10	19
8PLUG-S	7/8	1/2	12mPLUG-S	12	22
12PLUG-S	1-1/8	3/4	16mPLUG-S	16	27
16PLUG-S	1-1/2	1"	20mPLUG-S	20	32
			25mPLUG-S	25	38

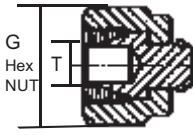

LOCK NUTS

Imperial Range Dimension in INCHES			Metric Range Dimension in mm		
Part Number	G Nut	L	Part Number	G Nut	L
2LN-S	0.51	0.23	6mLN-S	17	6
4LN-S	0.67	0.23	8mLN-S	17	6
6LN-S	0.75	0.23	10mLN-S	19	8
8LN-S	0.94	0.31	12mLN-S	24	8
12LN-S	1.18	0.35	16mLN-S	27	9
16LN-S	1.61	0.39	20mLN-S	32	10
			25mLN-S	41	10

- LN
- PL
- CP
- N
- CF

CAPS

Imperial Range Dimension in INCHES								Metric Range Dimension in mm							
Part	Tube	L1	C	D	F Nut	G	H	Part Number	Tube	L1	C	D	F Nut	G Nut	H
2CAP-S	1/8	0.81	0.63	0.53	1/2	7/16	0.53	6mCAP-S	6	25	19	17	14	14	16
4CAP-S	1/4	0.91	0.70	0.60	1/2	9/16	0.62	8mCAP-S	8	26	20	18	14	17	17
6CAP-S	3/8	1.01	0.76	0.66	5/8	11/16	0.7	10mCAP-S	10	26.5	20.5	18	17	19	18
8CAP-S	1/2	1.15	0.86	0.90	13/16	7/8	0.75	12mCAP-S	12	33	23	24	22	22	22
12CAP-S	3/4	1.24	0.86	0.86	1-1/16	1-1/8	0.84	16mCAP-S	16	35	24	26	24	27	23
16CAP-S	1"	1.51	1.04	1.23	1-3/8	1-1/2	1.03	20mCAP-S	20	42	27	29	30	32	27
								25mCAP-S	25	45.5	31	36	36	41	29

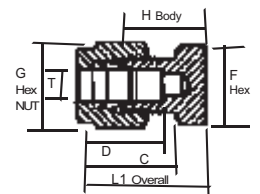

NUTS - Imperial & Metric

Imperial Range Dimension in INCHES				Metric Range Dimension in mm			
Part Number	Tube o/d	G Nut	L	Part Number	Tube o/d	G Nut	L
2N-S	1/8	7/16	0.47	6mN-S	6	14	13
4N-S	1/4	9/16	0.51	8mN-S	8	17	13.5
6N-S	3/8	11/16	0.57	10mN-S	10	19	15
8N-S	1/2	7/8	0.69	12mN-S	12	22	17.5
12N-S	3/4	1-1/8	0.69	16mN-S	16	27	17.5
16N-S	1"	1-1/2	0.82	20mN-S	20	32	17.5
				25mN-S	25	41	21

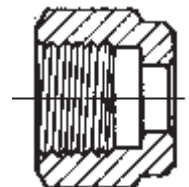

FERRULES - Imperial & Metric

Imperial Range Dimension in INCHES		Metric Range Dimension in mm	
Front & Back Ferrule Set	T Dia	Front & Back Ferrule Set	T Dia
2FRC-S	1/8	6mFRC-S	6
4FRC-S	1/4	8mFRC-S	8
6FRC-S	3/8	10mFRC-S	10
8FRC-S	1/2	12mFRC-S	12
12FRC-S	3/4	16mFRC-S	16
16FRC-S	1"	20mFRC-S	20
		25mFRC-S	25

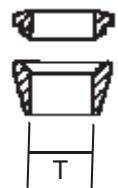

VOORRAADPROGRAMMA ROESTVASTSTAAL

STOCK PROGRAM STAINLESS STEEL

BUIZEN

GELASTE BUIZEN
ZUIVEL BUIZEN
CONSTRUCTIEBUIZ; rond, vierkant en rechthoekig
NAADLOZE BUIZEN
BUIZEN VOOR GASCHROMATOGRAFIE
CAPILLAIRE BUIZEN
INSTRUMENTATIE BUIZEN
INJECTIE-NAALD BUIZEN
PEKEL NAALDEN

FITTINGEN

GELASTE EN NAADLOZE LASFITTINGEN
bochten, t-stukken, verlopen, boordringen, kappen,
stub-ends
BEUGELS
BSP GASDRAAD FITTINGEN
3000# FITTINGEN NPT/SW
LAGEDRUK KLEMKOPPELINGEN
met EPDM of VITON ringen
KNEL FITTINGEN (DUBBELE RING)
SNIJRING FITTINGEN
ZUIVEL FITTINGEN
INOXPRES - FITTINGEN

FLENZEN

FLENZEN DIN EN/ANSI
ALUMINIUM FLENZEN

AFSLUITERS

BSP KOGELKRANEN, GEFLENSDE KOGELKRANEN,
SCHUIF- EN KLEPAFSLUITERS, TERUGSLAGKLEPPEN,
VLINDERKLEPPEN, STRAINERS

HOGEDRUK AFSLUITERS tot 15000 PSI

BSP KOGELKRANEN, GEFLENSDE KOGELKRANEN,
SCHUIF- EN KLEPAFSLUITERS, TERUGSLAGKLEPPEN,
NAALDAFSLUITERS, MANIFOLDS (INSTRUMENTATIE
AANSLUITING DIN 1.9213 OF NPT)

MANOMETER AFSLUITERS

MATERIAAL: ROESTVASTSTAAL EN STAAL
OP AANVRAAG LEVERBARE KWALITEITEN
MONEL, HASTELOY, INCONEL ENZ.

STAF en PROFIELEN

RONDSTAF
PLATSTAF
VIERKANT- EN ZESKANTSTAF
HOEK-, U- EN T-PROFIELEN

PLATEN

warm- en koudgewalst

TUBES

WELDED TUBES
DAIRY TUBES
CONSTRUCTION TUBES; round, square and rectangular
SEAMLESS TUBES
GAS-CHROMATOGRAPHY TUBES
CAPILLARY TUBES
INSTRUMENTATION TUBES
HYPERDERMIC NEEDLE TUBING
SALT INJECTOR NEEDLES

FITTINGS

WELDED AND SEAMLESS BW FITTINGS
elbows, tees, reducers, collars, caps,
stubends
CLIPS
BSP THREADED FITTINGS
3000# FITTINGS NPT/SW
LOW PRESSURE COMPRESSION COUPLINGS
with EPDM or VITON sealing rings
COMPRESSION TYPE FITTINGS (TWIN FERRULE)
CUTTINGRING FITTINGS
DAIRY FITTINGS
INOXPRES FITTINGS

FLANGES

FLANGES DIN EN/ANSI
ALUMINIUM FLANGES

VALVES

BSP THREADED BALL VALVES, FLANGED BALL VALVES
GATE- GLOBE- AND CHECK VALVES,
BUTTERFLY VALVES, STRAINERS

HIGH PRESSURE VALVES up to 15000 PSI

BSP THREADED BALL VALVES, FLANGED BALL VALVES
GATE-, GLOBE-, AND CHECK VALVES, NEEDLE VALVES
MANIFOLDS (INSTRUMENTATION CONNECTION
DIN 1.9213 OR NPT)

GAUGE VALVES

MATERIAL: STAINLESS STEEL AND STEEL
AVAILABLE GRADES UPON REQUEST
MONEL, HASTELOY, INCONEL ETC.

BARS en PROFIELEN

ROUND BARS
FLAT BARS
SQUARE AND HEXAGON BARS
ANGLE-, U- AND T-PROFILES

SHEETS & PLATES

hot and cold rolled



GESTAALDE SERVICE, ROESTVAST DE SNELSTE

POSTBUS 6096,5700 ET HELMOND

TEL:0492-582111 - FAX: 0492-538970

www.noxon.nl e-mail:info@noxon.nl