

ROESTVAST STAAL-STAINLESS STEEL

**GESMEDE HOGEDRUK FITTINGEN NPT & SOCKET WELD
STAINLESS STEEL FORGED FITTINGS CLASS 3000 LBS**

UIT VOORRAAD HELMOND

EX STOCK HELMOND

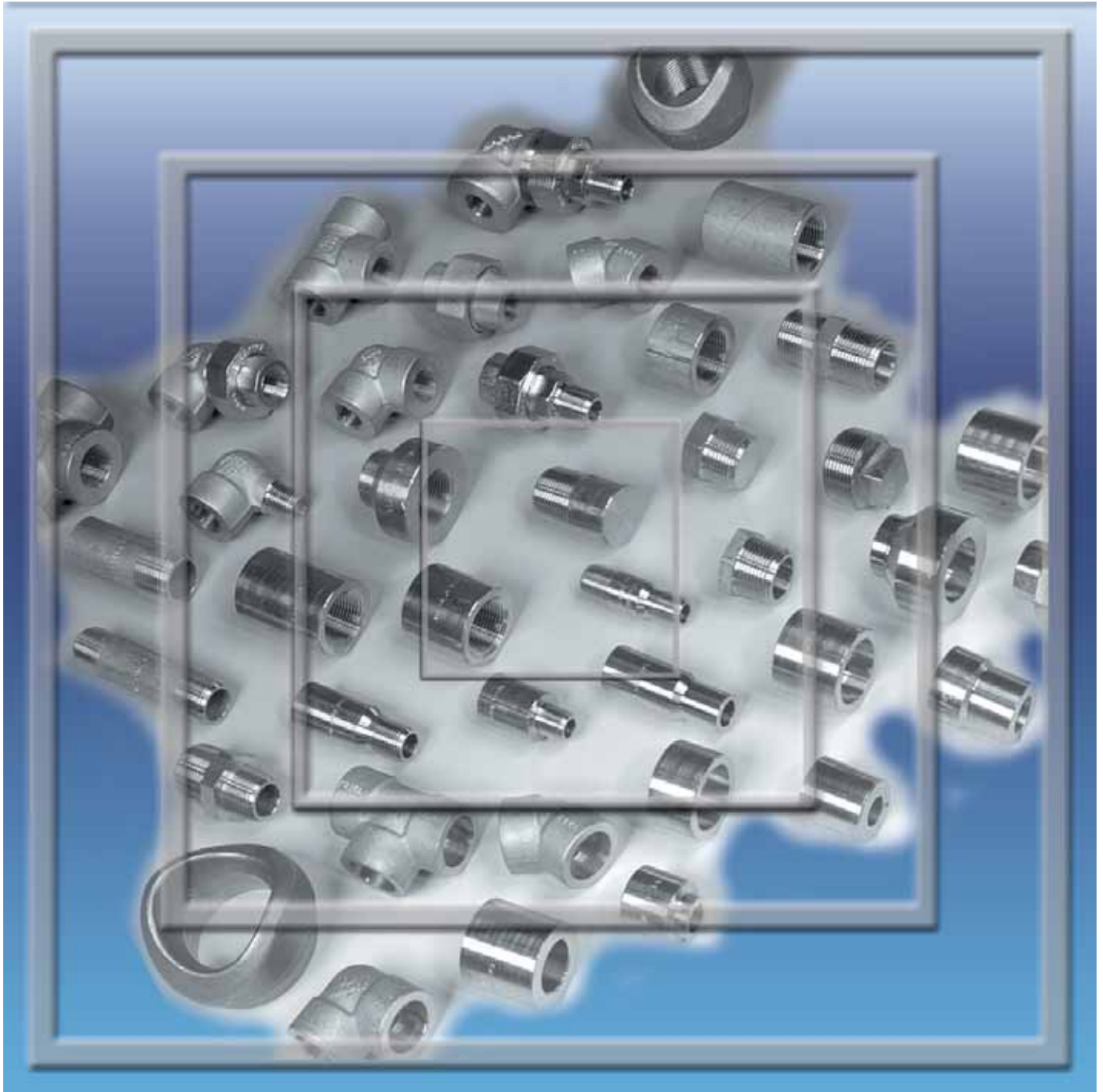

NOXON

2005-08

GESTAALDE SERVICE, ROESTVAST DE SNELSTE

POSTBUS 6096, 5700 ET HELMOND

TEL: +31 (0)492-582111 FAX: +31 (0)492-538970

www.noxon.nl info@noxon.nl



ALSO AVAILABLE UPON REQUEST
OOK BESCHIKBAAR OP AANVRAAG



Roestvast stalen gesmede HOGEDRUK FITTINGEN

Uitvoering ANSI B 16.11 Class 3000 lbs.
Materiaal volgens ASTM-A 182
NPT draad ANSI B2.1
Kwaliteit 304/L en 316/L
Class 6000 lbs. en hoger: op aanvraag

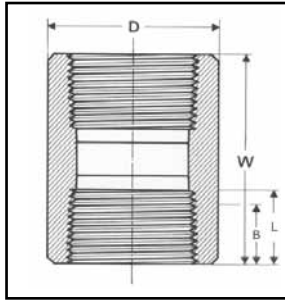

Coupling

Nom pipe size	A mm	W mm	H mm min	D mm nom	G mm min	B mm min	L *) mm min	theor kg/st	304/L 316/L	
									E	x
1/8"	--	32	--	16	--	6.5	6.5	0.03	E	x
1/4"	--	35	--	19	--	8.0	10.0	0.05	x	x
3/8"	--	38	--	22	--	9.0	10.5	0.06	x	x
1/2"	--	48	--	29	--	11.0	13.5	0.14	x	x
3/4"	--	51	--	35	--	12.5	14.0	0.20	x	x
1"	--	60	--	44	--	14.5	17.5	0.40	x	x
1.1/4"	--	67	--	57	--	17.0	18.0	0.70	x	x
1.1/2"	--	79	--	64	--	18.0	18.5	1.00	x	x
2"	--	86	--	76	--	19.0	19.0	1.90	x	x

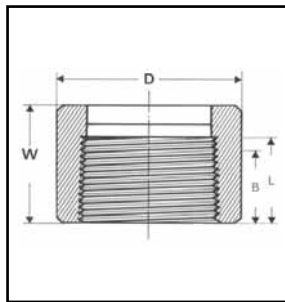

Half Coupling

Nom pipe size	A mm	W mm	H mm min	D mm nom	G mm min	B mm min	L *) mm min	theor kg/st	304/L 316/L	
									E	x
1/8"	--	16	--	16	--	6.5	6.5	0.02	E	x
1/4"	--	18	--	19	--	8.0	10.0	0.03	x	x
3/8"	--	19	--	22	--	9.0	10.5	0.05	x	x
1/2"	--	24	--	29	--	11.0	13.5	0.07	x	x
3/4"	--	26	--	35	--	12.5	14.0	0.10	x	x
1"	--	30	--	44	--	14.5	17.5	0.20	x	x
1.1/4"	--	34	--	57	--	17.0	18.0	0.32	x	x
1.1/2"	--	40	--	64	--	18.0	18.5	0.50	x	x
2"	--	43	--	76	--	19.0	19.0	0.95	x	x

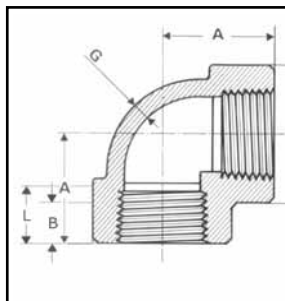

Elbow 90° f/f

Nom pipe size	A mm	W mm	H mm min	D mm nom	G mm min	B mm min	L *) mm min	theor kg/st	304/L 316/L	
									E	x
1/8"	21	--	--	22	3.0	6.5	6.5	0.07	E	x
1/4"	25	--	--	25	3.5	8.0	10.0	0.14	x	x
3/8"	29	--	--	33	3.5	9.0	10.5	0.27	x	x
1/2"	33	--	--	38	4.0	11.0	13.5	0.40	x	x
3/4"	38	--	--	46	4.5	12.5	14.0	0.63	x	x
1"	44	--	--	56	5.0	14.5	17.5	1.10	x	x
1.1/4"	51	--	--	62	5.5	17.0	18.0	1.22	x	x
1.1/2"	60	--	--	75	5.5	18.0	18.5	2.35	x	x
2"	64	--	--	84	7.0	19.0	19.0	3.30	x	x

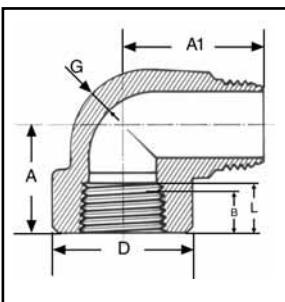

Elbow 90° m/f

Nom pipe size	A mm	W mm	A1 mm min	D mm nom	G mm min	B mm min	L *) mm min	theor kg/st	304/L 316/L	
									E	x
1/4"	25	--	27	25	3.5	8.0	10.0	0.14	x	x
3/8"	29	--	32	33	3.5	9.0	10.5	0.28	x	x
1/2"	33	--	36	38	4.0	11.0	13.5	0.46	x	x
3/4"	38	--	41	46	4.5	12.5	14.0	0.67	E	x
1"	44	--	50	56	5.0	14.5	17.5	1.18	E	x
1.1/4"	51	--	61	62	5.5	17.0	18.0	3.09	E	x
1.1/2"	60	--	70	75	5.5	18.0	18.5	2.45	E	x

x = voorraad Helmond, m.o.
E = voorraad Europa, 7-10 dagen, m.o.

x = stock Helmond, m.o.
E = stock Europe, 7-10 days, s.u.

Roestvast stalen gesmede HOGEDRUK FITTINGEN

Uitvoering ANSI B 16.11 Class 3000 lbs.
Materiaal volgens ASTM-A 182
NPT draad ANSI B2.1
Kwaliteit 304/L en 316/L
Class 6000 lbs. en hoger: op aanvraag

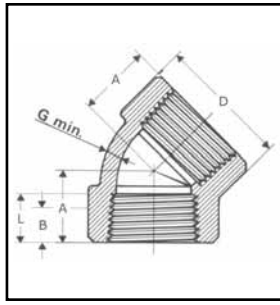

Elbow 45°

Stainless steel forged HIGH PRESSURE FITTINGS

Execution acc. to ANSI B 16.11 Class 3000 lbs.
Material acc. to ASTM-A 182
NPT thread ANSI B2.1
Grade 304/L en 316/L
Class 6000 lbs. and up: on request

Nom pipe size	A mm	W mm	H mm min	D mm nom	G mm min	B mm min	L *) mm min	theor kg/st		
									304/L	316/L
1/4"	19	--	--	25	3.5	8.0	10.0	0.14	E	x
3/8"	22	--	--	33	3.5	9.0	10.5	0.25	E	x
1/2"	25	--	--	38	4.0	11.0	13.5	0.32	E	x
3/4"	29	--	--	46	4.5	12.5	14.0	0.51	E	x
1"	33	--	--	56	5.0	14.5	17.5	0.85	E	x
1.1/4"	35	--	--	62	5.5	17.0	18.0	1.00	E	x
1.1/2"	43	--	--	75	5.5	18.0	18.5	1.85	E	x
2"	45	--	--	84	7.0	19.0	19.0	3.00	E	x

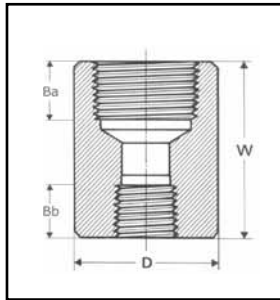

Reducing Coupling

Nom a	pipe size b	H mm min	D mm nom	W mm	B a mm min	B b mm min	theor kg/st		
								304/L	316/L
3/8"	x 1/4"	--	22	38	9.0	8.0	0.07	x	x
1/2"	x 1/4"	--	29	48	11.0	8.0	0.19	x	x
1/2"	x 3/8"	--	29	48	11.0	9.0	0.15	x	x
3/4"	x 1/4"	--	35	51	12.5	8.0	0.29	E	E
3/4"	x 1/2"	--	35	51	12.5	11.0	0.24	x	x
1"	x 1/4"	--	44	60	14.5	8.0	0.58	E	E
1"	x 1/2"	--	44	60	14.5	11.0	0.54	x	x
1"	x 3/4"	--	44	60	14.5	12.5	0.5	x	x
1.1/4"	x 1"	--	57	67	17.0	14.5	0.83	x	x
1.1/2"	x 1/2"	--	64	79	18.0	11.0	1.49	E	E
1.1/2"	x 3/4"	--	64	79	18.0	12.5	1.37	x	x
1.1/2"	x 1"	--	64	79	18.0	14.5	1.28	x	x
1.1/2"	x 1.1/4"	--	64	79	18.0	17.0	1.22	x	x
2"	x 1"	--	76	86	19.0	14.5	1.93	x	x
2"	x 1.1/4"	--	76	86	19.0	17.0	1.77	E	E
2"	x 1.1/2"	--	76	86	19.0	18.0	1.61	x	x

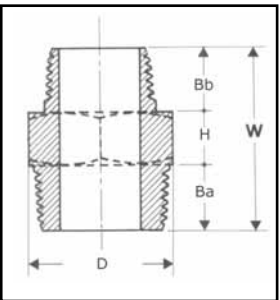

Hexagon Reducing Nipple

Nom a	pipe size b	H mm min	D mm nom	W mm	B a mm min	B b mm min	theor kg/st		
								304/L	316/L
1/4"	x 1/8"	6	16	27	11	10	0.04	E	x
3/8"	x 1/8"	8	16	31	13	10	0.05	E	x
3/8"	x 1/4"	8	16	32	13	11	0.05	x	x
1/2"	x 1/4"	8	22	34	15	11	0.08	x	x
1/2"	x 3/8"	8	22	36	15	13	0.08	x	x
3/4"	x 1/4"	9	27	36	16	11	0.08	E	x
3/4"	x 1/2"	9	27	40	16	15	0.10	x	x
1"	x 1/4"	10	35	40	19	11	0.17	E	x
1"	x 3/8"	10	35	42	19	13	0.17	E	x
1"	x 1/2"	10	35	44	19	15	0.21	x	x
1"	x 3/4"	10	35	45	19	16	0.20	x	x
1.1/4"	x 1"	14	45	54	21	19	0.39	x	x
1.1/2"	x 1/2"	16	51	52	21	15	0.34	E	E
1.1/2"	x 3/4"	16	51	53	21	16	0.50	E	E
1.1/2"	x 1"	16	51	56	21	19	0.52	x	x
1.1/2"	x 1.1/4"	16	51	58	21	21	0.54	x	x
2"	x 1/2"	17	63	54	22	15	1.00	E	E
2"	x 3/4"	17	63	55	22	16	0.98	E	E
2"	x 1"	17	63	58	22	19	0.96	x	x
2"	x 1.1/4"	17	63	60	22	21	0.95	x	x
2"	x 1.1/2"	17	63	60	22	21	0.94	x	x

Roestvast stalen gesmede HOGEDRUK FITTINGEN

Uitvoering ANSI B 16.11 Class 3000 lbs.
Materiaal volgens ASTM-A 182
NPT draad ANSI B2.1
Kwaliteit 304/L en 316/L
Class 6000 lbs. en hoger: op aanvraag

Stainless steel forged HIGH PRESSURE FITTINGS

Execution acc. to ANSI B 16.11 Class 3000 lbs.
Material acc. to ASTM-A 182
NPT thread ANSI B2.1
Grade 304/L en 316/L
Class 6000 lbs. and up: on request

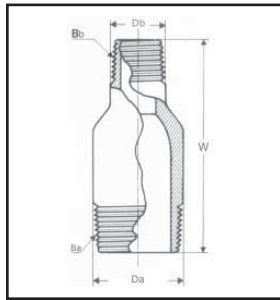

Concentric Swage
Nipple

Nom a	pipe x	size b	D a	D b	W	B a	B b	theor kg/ st		
			mm min	mm nom		mm	mm min		mm min	304/L
3/8"	x	1/4"	17.2	13.7	55	13	11	0.06	E	E
1/2"	x	1/4"	21.3	13.7	60	15	15	0.08	E	E
3/4"	x	1/2"	26.7	21.3	70	16	16	0.14	E	E
1"	x	1/2"	33.4	21.3	80	19	19	0.24	E	E
1"	x	3/4"	33.4	26.7	80	19	19	0.24	E	E
1.1/2"	x	1"	48.3	33.4	100	21	21	0.53	E	E
2"	x	1.1/2"	60.3	48.3	110	22	22	1.00	E	E



Roestvast stalen gesmede HOGEDRUK FITTINGEN

Uitvoering ANSI B 16.11 Class 3000 lbs.
Materiaal volgens ASTM-A 182
NPT draad ANSI B2.1
Kwaliteit 304\L en 316\L
Class 6000 lbs. en hoger: op aanvraag

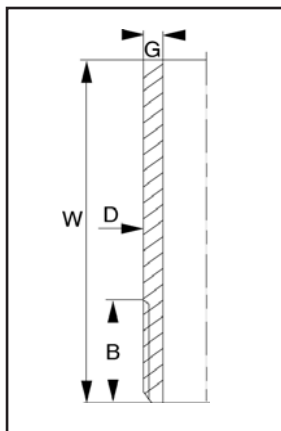

Pipenipple
T.O.E.

Stainless steel forged HIGH PRESSURE FITTINGS

Execution acc. to ANSI B 16.11 Class 3000 lbs.
Material acc. to ASTM-A 182
NPT thread ANSI B2.1
Grade 304\L en 316\L
Class 6000 lbs. and up: on request

Nom pipe size	A mm	W mm	H mm min	D mm nom	G mm min	B mm min	L *) mm min	theor kg/st		
									304/L	316/L
1/4"	--	50.8	--	13.7	3.0	11.0	--	0.02	x	x
1/4"	--	76.1	--	13.7	3.0	11.0	--	0.04	x	x
1/4"	--	101.6	--	13.7	3.0	11.0	--	0.05	x	x
3/8"	--	50.8	--	17.2	3.2	12.5	--	0.06	E	E
3/8"	--	76.1	--	17.2	3.2	12.5	--	0.09	x	x
3/8"	--	101.6	--	17.2	3.2	12.5	--	0.11	E	x
1/2"	--	50.8	--	21.3	3.7	14.5	--	0.08	x	x
1/2"	--	76.1	--	21.3	3.7	14.5	--	0.12	x	x
1/2"	--	101.6	--	21.3	3.7	14.5	--	0.17	x	x
3/4"	--	50.8	--	26.7	3.9	16.0	--	0.11	x	x
3/4"	--	76.1	--	26.7	3.9	16.0	--	0.17	x	x
3/4"	--	101.6	--	26.7	3.9	16.0	--	0.23	x	x
1"	--	50.8	--	33.4	4.6	19.0	--	0.17	x	x
1"	--	76.1	--	33.4	4.6	19.0	--	0.25	x	x
1"	--	101.6	--	33.4	4.6	19.0	--	0.33	x	x
1.1/4"	--	50.8	--	42.2	4.9	20.5	--	0.23	E	E
1.1/4"	--	76.1	--	42.2	4.9	20.5	--	0.34	E	E
1.1/4"	--	101.6	--	42.2	4.9	20.5	--	0.46	x	x
1.1/2"	--	50.8	--	48.3	5.1	20.5	--	0.28	E	x
1.1/2"	--	76.1	--	48.3	5.1	20.5	--	0.42	x	x
1.1/2"	--	101.6	--	48.3	5.1	20.5	--	0.56	E	x
2"	--	50.8	--	60.3	5.5	22.0	--	0.39	E	E
2"	--	76.1	--	60.3	5.5	22.0	--	0.58	E	x
2"	--	101.6	--	60.3	5.5	22.0	--	0.77	x	x

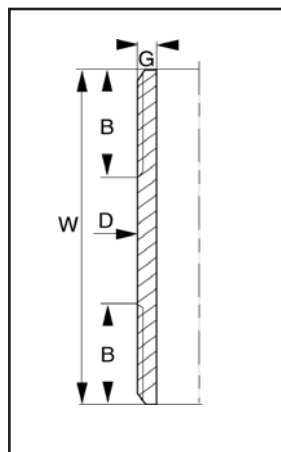

Pipenipple
T.B.E.

Nom pipe size	A mm	W mm	H mm min	D mm nom	G mm min	B mm min	L *) mm min	theor kg/st		
									304/L	316/L
1/4"	--	50.8	--	13.7	3.0	11.0	--	0.02	x	x
1/4"	--	76.1	--	13.7	3.0	11.0	--	0.04	x	x
1/4"	--	101.6	--	13.7	3.0	11.0	--	0.05	x	x
3/8"	--	50.8	--	17.2	3.2	12.5	--	0.06	x	x
3/8"	--	76.1	--	17.2	3.2	12.5	--	0.09	E	x
3/8"	--	101.6	--	17.2	3.2	12.5	--	0.11	E	x
1/2"	--	50.8	--	21.3	3.7	14.5	--	0.08	x	x
1/2"	--	76.1	--	21.3	3.7	14.5	--	0.12	x	x
1/2"	--	101.6	--	21.3	3.7	14.5	--	0.17	x	x
3/4"	--	50.8	--	26.7	3.9	16.0	--	0.11	E	x
3/4"	--	76.1	--	26.7	3.9	16.0	--	0.17	x	x
3/4"	--	101.6	--	26.7	3.9	16.0	--	0.23	x	x
1"	--	50.8	--	33.4	4.6	19.0	--	0.17	E	x
1"	--	76.1	--	33.4	4.6	19.0	--	0.25	x	x
1"	--	101.6	--	33.4	4.6	19.0	--	0.33	x	x
1.1/4"	--	50.8	--	42.2	4.9	20.5	--	0.23	E	E
1.1/4"	--	76.1	--	42.2	4.9	20.5	--	0.34	E	E
1.1/4"	--	101.6	--	42.2	4.9	20.5	--	0.46	x	x
1.1/2"	--	50.8	--	48.3	5.1	20.5	--	0.28	E	E
1.1/2"	--	76.1	--	48.3	5.1	20.5	--	0.42	E	E
1.1/2"	--	101.6	--	48.3	5.1	20.5	--	0.56	x	x
2"	--	50.8	--	60.3	5.5	22.0	--	0.39	E	E
2"	--	76.1	--	60.3	5.5	22.0	--	0.58	E	E
2"	--	101.6	--	60.3	5.5	22.0	--	0.77	x	x

x = voorraad Helmond, m.o.
E = voorraad Europa, 7-10 dagen, m.o.

x = stock Helmond, m.o.
E = stock Europe, 7-10 days, s.u.

Roestvast stalen gesmede HOGEDRUK FITTINGEN

Uitvoering ANSI B 16.11 Class 3000 lbs.
Materiaal volgens ASTM-A 182
NPT draad ANSI B2.1
Kwaliteit 304\L en 316\L
Class 6000 lbs. en hoger: op aanvraag

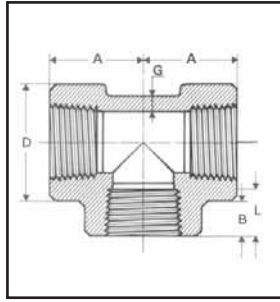

Tee

Stainless steel forged HIGH PRESSURE FITTINGS

Execution acc. to ANSI B 16.11 Class 3000 lbs.
Material acc. to ASTM-A 182
NPT thread ANSI B2.1
Grade 304\L en 316\L
Class 6000 lbs. and up: on request

Nom pipe size	A mm	W mm	H mm min	D mm nom	G mm min	B mm min	L *) mm min	theor kg/st	304/L 316/L	
1/4"	25	--	--	25	3.5	8.0	10.0	0.19	x	x
3/8"	29	--	--	33	3.5	9.0	10.5	0.39	x	x
1/2"	33	--	--	38	4.0	11.0	13.5	0.52	x	x
3/4"	38	--	--	46	4.5	12.5	14.0	0.83	x	x
1"	44	--	--	56	5.0	14.5	17.5	1.38	x	x
1.1/4"	51	--	--	52	5.5	17.0	18.0	1.66	x	x
1.1/2"	60	--	--	75	5.5	18.0	18.5	3.12	x	x
2"	64	--	--	84	7.0	19.0	19.0	4.00	x	x

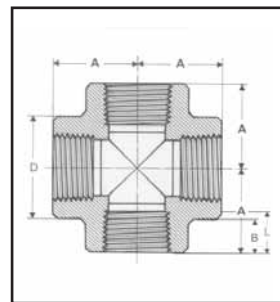

Cross

Nom pipe size	A mm	W mm	H mm min	D mm nom	G mm min	B mm min	L *) mm min	theor kg/st	304/L 316/L	
1/4"	25	--	--	25	3.5	8.0	10.0	0.24	E	E
3/8"	29	--	--	33	3.5	9.0	10.5	0.49	E	E
1/2"	33	--	--	38	4.0	11.0	13.5	0.65	E	E
3/4"	38	--	--	46	4.5	12.5	14.0	1.04	E	E
1"	44	--	--	56	5.0	14.5	17.5	1.73	E	E
1.1/4"	51	--	--	52	5.5	17.0	18.0	2.08	E	E
1.1/2"	60	--	--	75	5.5	18.0	18.5	3.90	E	E
2"	64	--	--	84	7.0	19.0	19.0	5.00	E	E

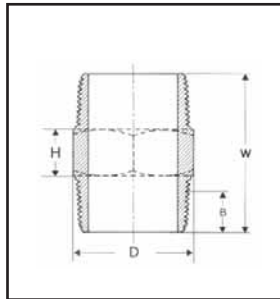

Hexagon Nipple

Nom pipe size	A mm	W mm	H mm min	D mm nom	G mm min	B mm min	L *) mm min	theor kg/st	304/L 316/L	
1/8"	--	26	6	11.0	--	9.5	--	0.01	x	x
1/4"	--	42	6	16.0	--	11.0	--	0.03	x	x
3/8"	--	47	8	17.5	--	12.5	--	0.06	x	x
1/2"	--	52	8	22.0	--	14.5	--	0.09	x	x
3/4"	--	57	10	27.0	--	16.0	--	0.12	x	x
1"	--	65	10	35.0	--	19.0	--	0.17	x	x
1.1/4"	--	72	14	44.5	--	20.5	--	0.29	x	x
1.1/2"	--	74	16	51.0	--	20.5	--	0.34	x	x
2"	--	78	17	63.0	--	22.0	--	0.55	x	x

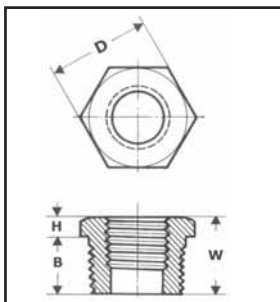

Hexagon Head Plug

Nom pipe size	A mm	W mm	H mm min	D mm nom	G mm min	B mm min	L *) mm min	theor kg/st	6000 lbs!!	
									304/L	316/L
1/8"	--	15.5	6	11.0	--	9.5	--	0.01	x	x
1/4"	--	17.0	6	16.0	--	11.0	--	0.03	x	x
3/8"	--	20.5	8	17.5	--	12.5	--	0.05	x	x
1/2"	--	22.5	8	22.0	--	14.5	--	0.08	x	x
3/4"	--	26.0	10	27.0	--	16.0	--	0.15	x	x
1"	--	29.0	10	35.0	--	19.0	--	0.25	x	x
1.1/4"	--	34.5	14	44.5	--	20.5	--	0.50	x	x
1.1/2"	--	36.5	16	51.0	--	20.5	--	0.65	x	x
2"	--	39.0	17	63.0	--	22.0	--	1.10	x	x

*) de gemiddelde wanddikte aan de rand van de soklaseinden mag niet minder zijn dan de aangegeven waarden. De minimum waarden zijn toegestaan in de aangegeven gebieden.

x = voorraad Helmond, m.o.
E = voorraad Europa, 7-10 dagen, m.o.

x = stock Helmond, m.o.
E = stock Europe, 7-10 days, s.u.

Roestvast stalen gesmede HOGEDRUK FITTINGEN

Uitvoering ANSI B 16.11 Class 3000 lbs.
Materiaal volgens ASTM-A 182
NPT draad ANSI B2.1
Kwaliteit 304/L en 316/L
Class 6000 lbs. en hoger: op aanvraag

Stainless steel forged HIGH PRESSURE FITTINGS

Execution acc. to ANSI B 16.11 Class 3000 lbs.
Material acc. to ASTM-A 182
NPT thread ANSI B2.1
Grade 304/L en 316/L
Class 6000 lbs. and up: on request

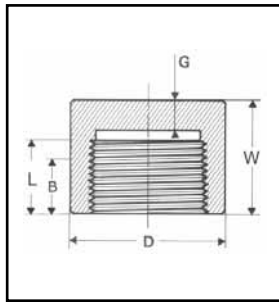

Round Cap

Nom pipe size	A mm	W mm	H mm min	D mm nom	G mm min	B mm min	L*) mm min	theor kg/st		
									304/L	316/L
1/8"	--	19	--	16	5.0	6.5	6.5	0.03	E	x
1/4"	--	25	--	19	5.0	8.0	10.0	0.05	x	x
3/8"	--	25	--	22	5.0	9.0	10.5	0.06	x	x
1/2"	--	32	--	29	6.5	11.0	13.5	0.12	x	x
3/4"	--	37	--	35	6.5	12.5	14.0	0.19	x	x
1"	--	41	--	44	9.5	14.5	17.5	0.35	x	x
1.1/4"	--	44	--	57	9.5	17.0	18.0	0.56	x	x
1.1/2"	--	44	--	64	11.0	18.0	18.5	0.75	x	x
2"	--	48	--	76	12.5	19.0	19.0	1.45	x	x

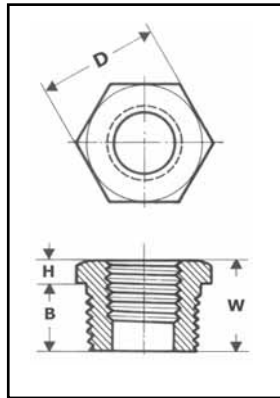

Hexagon Bushing

Nom pipe size	a	pipe size b	H mm min	D mm nom	W mm	B mm min	B b mm min	theor kg/st		
									304/L	316/L
1/4"	x	1/8"	3	17	14.0	11.0	--	0.02	E	E
3/8"	x	1/4"	4	21	16.5	12.5	--	0.03	x	x
1/2"	x	1/4"	5	23	19.5	14.5	--	0.06	x	x
1/2"	x	3/8"	5	23	19.5	14.5	--	0.06	x	x
3/4"	x	1/4"	6	27	22.0	16.0	--	0.12	E	x
3/4"	x	3/8"	6	29	22.0	16.0	--	0.10	E	E
3/4"	x	1/2"	6	29	22.0	16.0	--	0.09	x	x
1"	x	1/2"	6	35	25.0	19.0	--	0.15	x	x
1"	x	3/4"	6	35	25.0	19.0	--	0.11	x	x
1.1/4"	x	3/4"	7	45	27.5	20.5	--	0.09	E	x
1.1/4"	x	1"	7	46	27.5	20.5	--	0.12	x	x
1.1/2"	x	1/2"	8	50	28.5	20.5	--	0.28	E	x
1.1/2"	x	3/4"	8	50	28.5	20.5	--	0.24	E	x
1.1/2"	x	1"	8	50	28.5	20.5	--	0.20	x	x
1.1/2"	x	1.1/4"	8	50	28.5	20.5	--	0.16	x	x
2"	x	1/2"	9	63	31.0	22.0	--	0.50	E	E
2"	x	3/4"	9	63	31.0	22.0	--	0.45	E	E
2"	x	1"	9	63	31.0	22.0	--	0.41	x	x
2"	x	1.1/4"	9	63	31.0	22.0	--	0.37	x	x
2"	x	1.1/2"	9	63	31.0	22.0	--	0.33	x	x

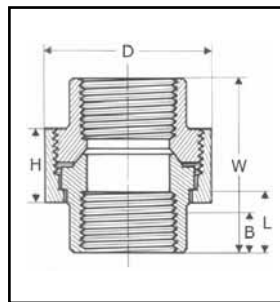

Union

Nom pipe size	A mm	W mm	H mm min	D mm nom	G mm min	B mm min	L*) mm min	theor kg/st		
									304/L	316/L
1/4"	--	45	18	32	--	8.0	10.0	0.13	x	x
3/8"	--	51	19	38	--	9.0	10.5	0.20	x	x
1/2"	--	54	21	46	--	11.0	13.5	0.40	x	x
3/4"	--	57	24	51	--	12.5	14.0	0.50	x	x
1"	--	69	25	60	--	14.5	17.5	1.00	x	x
1.1/4"	--	72	29	72	--	17.0	18.0	1.45	x	x
1.1/2"	--	80	30	77	--	18.0	18.5	1.60	x	x
2"	--	89	37	94	--	19.0	19.0	2.50	x	x

*) afmeting B is de minimum lengte van de perfecte draad. De lengte van de bruikbare draad zal niet minder zijn dan L.

x = voorraad Helmond, m.o.
E = voorraad Europa, 7-10 dagen, m.o.

x = stock Helmond, m.o.
E = stock Europe, 7-10 days, s.u.

Roestvast stalen gesmede HOGEDRUK FITTINGEN

Uitvoering ANSI B 16.11 Class 3000 lbs.
Materiaal volgens ASTM-A 182
NPT draad ANSI B2.1
Kwaliteit 304/L en 316/L
Class 6000 lbs. en hoger: op aanvraag

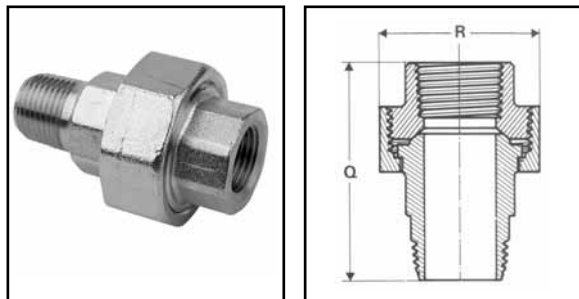

Union Concentric
male/female

Stainless steel forged HIGH PRESSURE FITTINGS

Execution acc. to ANSI B 16.11 Class 3000 lbs.
Material acc. to ASTM-A 182
NPT thread ANSI B2.1
Grade 304/L en 316/L
Class 6000 lbs. and up: on request

Nom pipe size	W mm	H mm min	D mm nom	G mm min	B mm min	L *) mm min	L1 mm min	theor kg/ st		
									304/L	316/L
1/4"	--	18.0	32	--	8.0	10.0	11.0	0.20	E	x
3/8"	--	19.0	38	--	9.0	10.5	12.5	0.25	E	x
1/2"	--	21.0	46	--	11.0	13.5	14.5	0.44	E	x
3/4"	--	24.0	51	--	12.5	14.0	16.0	0.60	E	x
1"	--	25.0	60	--	14.5	17.5	19.0	0.80	E	x
1.1/4"	--	29.0	72	--	17.0	18.0	20.5	1.25	E	x
1.1/2"	--	30.0	77	--	18.0	18.5	20.5	1.67	E	x
2"	--	37.0	94	--	19.0	19.0	22.0	2.65	E	x

Roestvast stalen gesmede HOGEDRUK FITTINGEN

Uitvoering ANSI B 16.11 Class 3000 lbs.
Materiaal volgens ASTM-A 182
Socket weld einden
Kwaliteit 304/L en 316/L
Class 6000 lbs. en hoger: op aanvraag

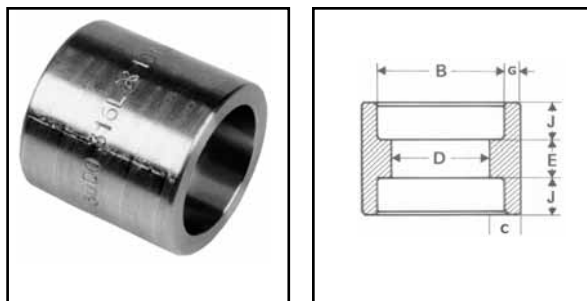

Coupling

Stainless steel forged HIGH PRESSURE FITTINGS

Execution acc. to ANSI B 16.11 Class 3000 lbs.
Material acc. to ASTM-A 182
Socket weld ends
Grade 304/L en 316/L
Class 6000 lbs. and up: on request

Nom pipe size	B		C *)		D		E		G mm min	J mm min	theor kg/ st		
	mm max	mm min	mm ave	mm min	mm max	mm min	mm max	mm min				304/L	316/L
1/4"	14.35	14.10	3.80	3.30	10.0	8.5	8	5	3.00	10	0.05	x	x
3/8"	17.80	17.55	4.00	3.50	13.3	11.8	9	3	3.20	10	0.10	x	x
1/2"	21.95	21.70	4.65	4.10	16.6	15.0	13	6	3.75	10	0.14	x	x
3/4"	27.30	27.05	4.90	4.25	21.7	20.2	13	6	3.90	13	0.20	x	x
1"	34.05	33.80	5.70	5.00	27.4	25.9	17	9	4.55	13	0.30	x	x
1.1/4"	42.80	42.55	6.05	5.30	35.8	34.3	17	9	4.85	13	0.45	x	x
1.1/2"	48.90	48.65	6.35	5.55	41.7	40.1	17	9	5.10	13	0.60	x	x
2"	61.35	61.10	6.95	6.05	53.5	51.7	23	15	5.55	16	0.95	x	x

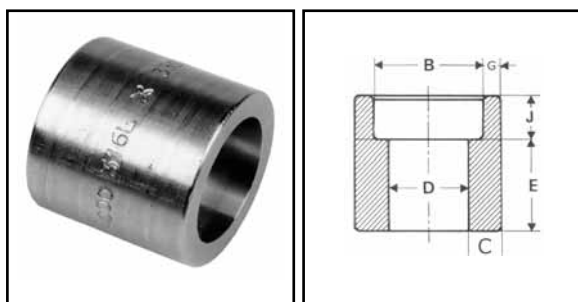

Half Coupling

Nom pipe size	B		C *)		D		E		G mm min	J mm min	theor kg/ st		
	mm max	mm min	mm ave	mm min	mm max	mm min	mm max	mm min				304/L	316/L
1/4"	14.35	14.10	3.80	3.30	10.0	8.5	17	15	3.00	10	0.06	x	x
3/8"	17.80	17.55	4.00	3.50	13.3	11.8	19	16	3.20	10	0.11	x	x
1/2"	21.95	21.70	4.65	4.10	16.6	15.0	24	21	3.75	10	0.15	x	x
3/4"	27.30	27.05	4.90	4.25	21.7	20.2	25	22	3.90	13	0.21	x	x
1"	34.05	33.80	5.70	5.00	27.4	25.9	31	27	4.55	13	0.35	x	x
1.1/4"	42.80	42.55	6.05	5.30	35.8	34.3	32	28	4.85	13	0.50	x	x
1.1/2"	48.90	48.65	6.35	5.55	41.7	40.1	34	30	5.10	13	0.65	x	x
2"	61.35	61.10	6.95	6.05	53.5	51.7	43	39	5.55	16	1.10	x	x

*) de gemiddelde wanddikte aan de rand van de sokklaseinden mag niet minder zijn dan de aangegeven waarden. De minimum waarden zijn toegestaan in de aangegeven gebieden.

Roestvast stalen gesmede HOGEDRUK FITTINGEN

Uitvoering ANSI B 16.11 Class 3000 lbs.
Materiaal volgens ASTM-A 182
NPT draad ANSI B2.1
Kwaliteit 304/L en 316/L
Class 6000 lbs. en hoger: op aanvraag

Stainless steel forged HIGH PRESSURE FITTINGS

Execution acc. to ANSI B 16.11 Class 3000 lbs.
Material acc. to ASTM-A 182
NPT thread ANSI B2.1
Grade 304/L en 316/L
Class 6000 lbs. and up: on request

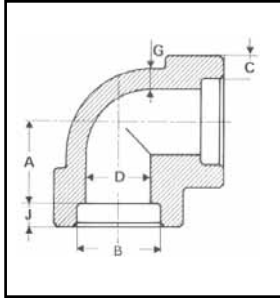

Elbow 90°

Nom pipe size	B		C *)		D		A		G	J	theor kg/ st	304/L	316/L
	mm max	mm min	mm ave	mm min	mm max	mm min	mm max	mm min					
1/4"	14.35	14.10	3.80	3.30	10.0	8.5	12	10	3.00	10	0.09	x	x
3/8"	17.80	17.55	4.00	3.50	13.3	11.8	15	12	3.20	10	0.13	x	x
1/2"	21.95	21.70	4.65	4.10	16.6	15.0	17	14	3.75	10	0.25	x	x
3/4"	27.30	27.05	4.90	4.25	21.7	20.2	21	18	3.90	13	0.32	x	x
1"	34.05	33.80	5.70	5.00	27.4	25.9	24	20	4.55	13	0.52	x	x
1.1/4"	42.80	42.55	6.05	5.30	35.8	34.3	29	25	4.85	13	0.86	x	x
1.1/2"	48.90	48.65	6.35	5.55	41.7	40.1	34	30	5.10	13	1.12	x	x
2"	61.35	61.10	6.95	6.05	53.5	51.7	40	36	5.55	16	1.80	x	x

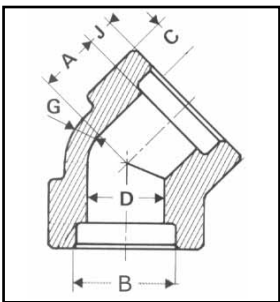

Elbow 45°

Nom pipe size	B		C *)		D		A		G	J	theor kg/ st	304/L	316/L
	mm max	mm min	mm ave	mm min	mm max	mm min	mm max	mm min					
1/4"	14.35	14.10	3.80	3.30	10.0	8.5	9	7	3.00	10	0.08	E	E
3/8"	17.80	17.55	4.00	3.50	13.3	11.8	9	6	3.20	10	0.13	E	x
1/2"	21.95	21.70	4.65	4.10	16.6	15.0	13	10	3.75	10	0.18	E	x
3/4"	27.30	27.05	4.90	4.25	21.7	20.2	14	11	3.90	13	0.30	E	x
1"	34.05	33.80	5.70	5.00	27.4	25.9	16	12	4.55	13	0.45	E	x
1.1/4"	42.80	42.55	6.05	5.30	35.8	34.3	19	15	4.85	13	0.75	E	x
1.1/2"	48.90	48.65	6.35	5.55	41.7	40.1	23	19	5.10	13	0.90	E	x
2"	61.35	61.10	6.95	6.05	53.5	51.7	27	23	5.55	16	1.30	E	x

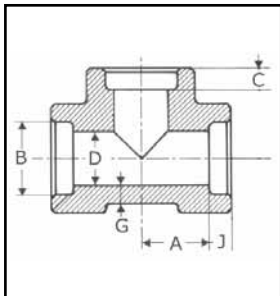

Tee

Nom pipe size	B		C *)		D		A		G	J	theor kg/ st	304/L	316/L
	mm max	mm min	mm ave	mm min	mm max	mm min	mm max	mm min					
1/4"	14.35	14.10	3.80	3.30	10.0	8.5	12	10	3.00	10	0.11	x	x
3/8"	17.80	17.55	4.00	3.50	13.3	11.8	15	12	3.20	10	0.16	x	x
1/2"	21.95	21.70	4.65	4.10	16.6	15.0	17	14	3.75	10	0.34	x	x
3/4"	27.30	27.05	4.90	4.25	21.7	20.2	21	18	3.90	13	0.41	x	x
1"	34.05	33.80	5.70	5.00	27.4	25.9	24	20	4.55	13	0.65	x	x
1.1/4"	42.80	42.55	6.05	5.30	35.8	34.3	29	25	4.85	13	0.95	x	x
1.1/2"	48.90	48.65	6.35	5.55	41.7	40.1	34	30	5.10	13	1.35	x	x
2"	61.35	61.10	6.95	6.05	53.5	51.7	40	36	5.55	16	2.20	x	x

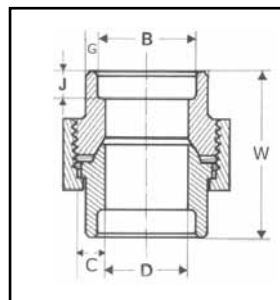

Union

Nom pipe size	B		C *)		D		W	H	G	J	theor kg/ st	304/L	316/L
	mm max	mm min	mm ave	mm min	mm max	mm min							
1/4"	14.35	14.10	3.80	3.30	10.0	8.5	45	32	3.00	10	0.20	x	x
3/8"	17.80	17.55	4.00	3.50	13.3	11.8	52	38	3.20	10	0.35	x	x
1/2"	21.95	21.70	4.65	4.10	16.6	15.0	54	46	3.75	10	0.40	x	x
3/4"	27.30	27.05	4.90	4.25	21.7	20.2	57	51	3.90	13	0.45	x	x
1"	34.05	33.80	5.70	5.00	27.4	25.9	64	60	4.55	13	1.00	x	x
1.1/4"	42.80	42.55	6.05	5.30	35.8	34.3	74	72	4.85	13	1.30	x	x
1.1/2"	48.90	48.65	6.35	5.55	41.7	40.1	80	77	5.10	13	1.70	x	x
2"	61.35	61.10	6.95	6.05	53.5	51.7	89	94	5.55	16	3.00	x	x

*) afmeting B is de minimum lengte van de perfecte draad. De lengte van de bruikbare draad zal niet minder zijn dan L.

x = voorraad Helmond, m.o.
E = voorraad Europa, 7-10 dagen, m.o.

x = stock Helmond, m.o.
E = stock Europe, 7-10 days, s.u.

Roestvast stalen gesmede HOGEDRUK FITTINGEN

Uitvoering ANSI B 16.11 Class 3000 lbs.
Materiaal volgens ASTM-A 182
Socket Weld ends
Kwaliteit 304/L en 316/L
Class 6000 lbs. en hoger: op aanvraag

Stainless steel forged HIGH PRESSURE FITTINGS

Execution acc. to ANSI B 16.11 Class 3000 lbs.
Material acc. to ASTM-A 182
Socket-weld ends
Grade 304/L en 316/L
Class 6000 lbs. and up: on request



Round Cap

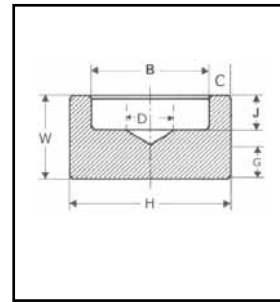

Nom pipe size	B		C *)		D		W mm	H mm	G mm min	J mm min	theor kg/ st	304/L	316/L
	mm max	mm min	mm ave	mm min	mm max	mm min							
1/4"	14.35	14.10	3.80	3.30	10.0	8.5	26	21	5.0	10	0.05	E	x
3/8"	17.80	17.55	4.00	3.50	13.3	11.8	26	25	5.0	10	0.06	E	x
1/2"	21.95	21.70	4.65	4.10	16.6	15.0	29	31	6.5	10	0.14	E	x
3/4"	27.30	27.05	4.90	4.25	21.7	20.2	36	36	6.5	13	0.20	E	x
1"	34.05	33.80	5.70	5.00	27.4	25.9	39	45	9.5	13	0.40	E	x
1.1/4"	42.80	42.55	6.05	5.30	35.8	34.3	39	55	9.5	13	0.70	E	x
1.1/2"	48.90	48.65	6.35	5.55	41.7	40.1	39	60	11.0	13	1.00	E	x
2"	61.35	61.10	6.95	6.05	53.5	51.7	51	75	12.5	16	1.90	E	x



Reducing Coupling

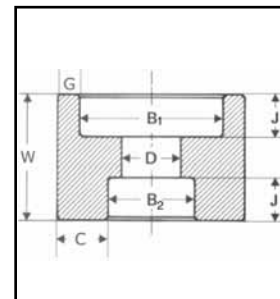

Nom	pipe	size	B1		B2		D		C	G	J	W	theor kg/st	304/L	316/L
			mm min	mm max	mm max	mm min	mm max	mm min							
3/8"	x	1/4"	17.55	17.80	14.35	14.10	13.3	11.8	5.33	3.50	10.0	29.0	0.06	E	x
1/2"	x	1/4"	21.70	21.95	14.35	14.10	16.6	15.0	8.33	4.10	10.0	33.0	0.19	E	x
1/2"	x	3/8"	21.70	21.95	17.80	17.55	16.6	15.0	6.60	4.10	10.0	33.0	0.14	E	E
3/4"	x	1/2"	27.05	27.30	21.95	21.70	21.7	20.2	7.03	4.25	10.0	33.0	0.23	E	x
1"	x	1/2"	33.80	34.05	21.95	21.70	27.4	25.9	11.53	5.00	13.0	43.0	0.54	E	x
1"	x	3/4"	33.80	34.05	27.30	27.05	27.4	25.9	8.85	5.00	13.0	43.0	0.50	E	x
1.1/4"	x	1"	42.55	42.80	34.05	33.80	35.8	34.3	10.48	5.30	13.0	43.0	0.83	E	x
1.1/2"	x	3/4"	48.65	48.90	21.95	21.70	41.7	40.1	19.03	5.55	13.0	43.0	1.37	E	x
1.1/2"	x	1/2"	48.65	48.90	27.30	27.05	41.7	40.1	16.35	5.55	13.0	43.0	1.49	E	x
1.1/2"	x	1"	48.65	48.90	34.05	33.80	41.7	40.1	12.98	5.55	13.0	43.0	1.28	E	x
2"	x	1/2"	61.10	61.35	21.95	21.70	53.5	51.7	26.53	6.05	16.0	55.0	2.25	E	E
2"	x	1"	61.10	61.35	34.05	33.80	53.5	51.7	20.48	6.05	16.0	55.0	1.93	E	x
2"	x	1.1/4"	61.10	61.35	42.80	42.55	53.5	51.7	16.10	6.05	16.0	55.0	1.45	E	x
2"	x	1.1/2"	61.10	61.35	48.90	48.65	53.5	51.7	13.05	6.05	16.0	55.0	1.61	E	x

*) de gemiddelde wanddikte aan de rand van de soklaseinden mag niet minder zijn dan de aangegeven waarden. De minimum waarden zijn toegestaan in de aangegeven gebieden.

x = voorraad Helmond, m.o.
E = voorraad Europa, 7-10 dagen, m.o.

x = stock Helmond, m.o.
E = stock Europe, 7-10 days, s.u.

ROESTVAST STAAL-STAINLESS STEEL

VOORRAADPROGRAMMA ROESTVAST STAAL

STOCK PROGRAM STAINLESS STEEL

BUIZEN

GELASTE BUIZEN

ZUIVEL BUIZEN

CONSTRUCTIEBUIZ; rond, vierkant en rechthoekig

NAADLOZE BUIZEN

BUIZEN VOOR GASCHROMATOGRAPHIE

CAPILLAIRE BUIZEN

INSTRUMENTATIE BUIZEN

INJECTIE-NAALD BUIZEN

PEKEL NAALDEN

FITTINGEN

GELASTE EN NAADLOZE LASFITTINGEN

bochten, t-stukken, verlopen, boordringen, kappen,

stub-ends

BEUGELS

BSP GASDRAAD FITTINGEN

3000# FITTINGEN NPT/SW

LAGEDRUK KLEMKOPPELINGEN

met EPDM of VITON ringen

KNEL FITTINGEN (DUBBELE RING)

SNIJRING FITTINGEN

ZUIVEL FITTINGEN

PRESS FITTINGEN

FLENZEN

FLENZEN DIN/ANSI

ALUMINIUM FLENZEN

AFSLUITERS

BSP KOGELKRANEN, GEFLENSDE KOGELKRANEN,

SCHUIF- EN KLEPAFSLUITERS, TERUGSLAGKLEPPEN,

VLINDERKLEPPEN, STRAINERS

HOGEDRUK AFSLUITERS tot 15000 PSI

BSP KOGELKRANEN, GEFLENSDE KOGELKRANEN,

SCHUIF- EN KLEPAFSLUITERS, TERUGSLAGKLEPPEN,

NAALDAFSLUITERS, MANIFOLDS (INSTRUMENTATIE

AANSLUITING DIN 1.9213 OF NPT)

MANOMETER AFSLUITERS

MATERIAAL: ROESTVAST STAAL EN STAAL

OP AANVRAAG LEVERBARE KWALITEITEN

MONEL, HASTELOY, INCONEL ENZ.

STAF en PROFIELEN

RONDSTAF

PLATSTAF

VIERKANTSTAF

HOEK-, U- EN T-PROFIELEN

PLATEN

warm- en koudgewalst

TUBES

WELDED TUBES

DAIRY TUBES

CONSTRUCTION TUBES; round, square and rectangular

SEAMLESS TUBES

GAS-CHROMATOGRAPHY TUBES

CAPILLARY TUBES

INSTRUMENTATION TUBES

HYPERDERMIC NEEDLE TUBING

SALT INJECTOR NEEDLES

FITTINGS

WELDED AND SEAMLESS BW FITTINGS

elbows, tees, reducers, collars, caps,

stubends

CLIPS

BSP THREADED FITTINGS

3000# FITTINGS NPT/SW

LOW PRESSURE COMPRESSION COUPLINGS

with EPDM or VITON sealing rings

COMPRESSION TYPE FITTINGS (TWIN FERRULE)

CUTTINGRING FITTINGS

DAIRY FITTINGS

PRESS FITTINGS

FLANGES

FLANGES DIN/ANSI

ALUMINIUM FLANGES

VALVES

BSP THREADED BALL VALVES, FLANGED BALL VALVES

GATE- GLOBE- AND CHECK VALVES,

BUTTERFLY VALVES, STRAINERS

HIGH PRESSURE VALVES up to 15000 PSI

BSP THREADED BALL VALVES, FLANGED BALL VALVES

GATE-, GLOBE-, AND CHECK VALVES, NEEDLE VALVES

MANIFOLDS (INSTRUMENTATION CONNECTION

DIN 1.9213 OR NPT)

GAUGE VALVES

MATERIAL: STAINLESS STEEL AND STEEL

AVAILABLE GRADES UPON REQUEST

MONEL, HASTELOY, INCONEL ETC.

BARS en PROFIELEN

ROUND BARS

FLAT BARS

SQUARE BARS

ANGLE-, U- AND T-PROFILES

SHEETS & PLATES

hot and cold rolled

NOXON

AS TOUGH AS STEEL IN STAINLESS

P.O. BOX 6096, NL-5700 ET HELMOND, THE NETHERLANDS

PHONE: +31 (0)492-582111 FAX: +31 (0)492-538970

www.noxon.nl info@noxon.nl